

LAMB COUNTY, TEXAS

* * *

Introduction

by

Samuel F. Turner

Associate Hydraulic Engineer

U. S. Geological Survey

The purpose of this survey was to obtain information concerning existing wells and the quantity and quality of water they yield, and to put down test holes where additional information was needed.

This project was part of a statewide Works Progress Administration project known as a "Statewide Inventory of Water Wells," sponsored by the State Board of Water Engineers. The Division of Ground Water of the U. S. Geological Survey cooperated in the technical direction of the project and the Bureau of Industrial Chemistry of The University of Texas furnished laboratory space and equipment and supervised the chemical analyses.

The analyses were made by chemists employed on Works Progress Administration Project 6507-5112 at Austin, Texas, sponsored by the State Board of Water Engineers. This release was typed and assembled by typists and draftsmen employed on this project.

The field work in Lamb County was started on February 1, 1937, and completed on June 10, 1937. This work was done as Project 2070 of District 17 of the Works Progress Administration, Lubbock, Texas. **W. L. Broadhurst**, a geologist, was project superintendent. **Mr. Broadhurst** should be given credit for his great interest in the work and for the many extra hours he spent on the project. The office of the Works Progress Administration in the Lubbock District made this work possible by their constant help and cooperation.

This release contains the well records and well logs obtained by the project superintendent, logs of the test holes drilled by the W. P. A. labor, and the chemical analyses of water from privately owned wells. Locations of all wells listed are shown on the map in the back of the release.

The test wells were drilled by W. P. A. labor using a soil auger, drop auger, churn drill, and a sand bucket. Samples were collected at one foot intervals by the well driller in charge of the party. The project superintendent studied these samples and compiled the logs.

Records of wells and springs in Lamb County, Texas
 (All wells are drilled unless otherwise noted in "Remarks" column.)
 (See "Logs of W. P. A. test wells" for records of test wells.)

No.	Distance from Earth	Section or Labor	Survey, Block or League	Owner	Driller	Topographic situation	Date completed	Depth of well (ft.)	Diameter of well (in.)
e/ 1	12 miles northwest	Sec. 14, NW cor., SE $\frac{1}{4}$	blk. W	H. H. Englekling	A. B. Hayes	Slope	1935	128	--
e/ 2	11 $\frac{1}{2}$ miles west	Sec. 19, NE cor., SW $\frac{1}{4}$	do.	Fred P. Warren	-- White	do.	1935	69	--
e/ 3	do.	Sec. 30, NW cor., SW $\frac{1}{4}$	do.	J. O. Crawford	A. B. Hayes	do.	--	105	--
e/ 3a	do.	do.	do.	do.	J. O. Crawford	Rolling	1934	82	24
e/ 4	do.	Sec. 35, NW cor., NW $\frac{1}{4}$	do.	H. S. Crawford	H. S. Crawford	Slope	1935	125	16
e/ 6	do.	do.	do.	Albert Lavigne	Dempster Co.	Flat	1913	150	16
e/ 7	do.	Sec. 46, NW cor., NE $\frac{1}{4}$	do.	Lillie Bickel	Harry Wilterding	do.	1915	104	12
e/ 8	11 miles west	Sec. 51, NW cor., NE $\frac{1}{4}$	do.	J. L. Withrow	A. B. Hayes	do.	1931	41	16
10	10 $\frac{1}{2}$ miles west	Sec. 61, SW $\frac{1}{4}$	Warren sur., blk. W	Malsell Cattle Co.	--	Rolling	--	21	--
e/ 12	do.	Sec. 45, NW cor., SW $\frac{1}{4}$	blk. W	Luther Hamn	--	Flat	1929	86	24
e/ 13	do.	Sec. 45, NW cor.	do.	John Fyie	Harry Wilterding	Slope	1917	150	13
e/ 14	do.	Sec. 36 NW cor., SW $\frac{1}{4}$	do.	Fred P. Warren	Dempster Co.	Flat	1913	100	10
e/ 15	do.	do.	do.	Fred J. Determan	do.	do.	1918	100	10

a/ Measuring point was usually top of casing, top of pump base, or top of well curb.
 b/ Measuring point above ground unless below ground indicated by minus (-) sign.
 c/ C, cylinder; T, turbine; Cf, centrifugal; W, windmill; G, gasoline engine; E, electric motor; Tr, tractor; D, diesel; H, hand; B, bucket or bailer; number indicates horsepower.

Records obtained by W. L. Broadhurst, Project Superintendent
 (Chemical analyses of water from these wells and springs are in the table of analyses.)

No.	Height of measuring point above ground (ft.) _{a/b/}	Water Level		Pump and power _{c/}	Use of water _{d/}	Remarks
		Depth below measuring point (ft.)	Date of measurement			
1	1.5	70.4	Nov. 10, 1936 _{f/}	T, Tr, --	I	
		70.5	Jan. 25, 1937			
2	1	51.7	Jan. 25, 1937 _{f/}	T, G, 30	I	Pump set at 64 feet. Measured yield, 1,040 gallons a minute.
3	- 0.3	27	Nov. 14, 1937	Cf, Tr, --	I	Water reported in sand and gravel at 26 to 105 feet. Reported 16 feet drawdown pumping 700 gallons a minute.
3a	0.8	30.7	Oct. 23, 1936	T, Tr, 80	--	Water reported in sand below 27 feet. Reported 17 to 20 feet drawdown pumping 1,000 gallons a minute. Pump operated 720 hours in 1936.
		30.8	Jan. 25, 1937			
4	0	26.3	Oct. 27, 1936 _{f/}	Cf, Tr, 40	I	Water reported in sand and caliche 24 to 60 feet. Reported 15 to 16 feet drawdown pumping 900 gallons a minute. Reported irrigates 35 acres. Pump operated 120 hours in 1936.
		26	Jan. 25, 1937			
6	-17.5	2.6	Mar. 15, 1937	Cf, Tr, 20	I	Reported 15 feet drawdown pumping 800 gallons a minute. Reported irrigates 70 acres. Pump operated 500 hours in 1936.
7	0.2	14	Nov. 14, 1934 _{f/}	Cf, Tr, --	I	Concrete curb; steel casing. Water reported in sand. Reported yield, 1,100 gallons a minute. Pump operated 580 hours in 1936.
		15.7	May 9, 1936 _{f/}			
		15.5	Jan. 25, 1937			
8	0.1	15.9	Oct. 26, 1936	Cf, G, 25	I	Estimated yield, 1,100 gallons a minute. Reported irrigates 100 acres. Pump operated 300 hours in 1936.
		15.6	Jan. 26, 1937			
10	0	14.6	Mar. 16, 1937	C, W	S	Strong supply.
12	-10.4	4.7	Oct. 26, 1936	Cf, G, --	I	Reported 9 to 11 feet drawdown pumping 750 gallons a minute. Reported irrigates 35 acres. Pump operated 140 hours in 1936.
		5.4	Jan. 26, 1937			
13	-19.1	2.6	Nov. 14, 1934 _{f/}	Cf, G, --	I	Reported irrigates 140 acres. Pump operated 300 hours in 1936.
	0.5	19.9	Oct. 26, 1936 _{f/}			
	0.5	19.6	Jan. 26, 1937			
	0.5	19	June 24, 1937			
14	--	--	--	Cf, E, 30	I	Reported irrigates 150 acres. Pump operated 2,310 hours in 1936.
15	-24.2	2	Oct. 30, 1936	Cf, Tr, 30	I	Reported 18 feet drawdown pumping 1,000 gallons a minute. Reported irrigates 160 acres. Pump operated 240 hours in 1936.
		1.5	Jan. 26, 1937			

_{d/} D, domestic; S, stock; I, irrigation; P, public; N, not used.

_{e/} No water sample collected for analysis.

_{f/} Water level reported.

Records of wells and springs in Lamb County--Continued

No.	Distance from Earth	Section or Labor	Survey, Block or League	Owner	Driller	Topographic situation	Date completed	Depth of well (ft.)	Diameter of well (in.)
e/ 16	11 miles west	Sec. 30, NW cor., NE $\frac{1}{2}$ SE $\frac{1}{4}$	blk. W	R. L. Brown	A. B. Hayes	Rolling	1933	100	--
17	9 $\frac{1}{2}$ miles northwest	Sec. 21, NE $\frac{1}{2}$ NE $\frac{1}{4}$	do.	--	--	--	--	66	4 $\frac{1}{2}$
e/ 19	10 miles west	Sec. 36, NW cor., SE $\frac{1}{2}$	do.	Josephene Roubineck	Harry Wilterding	Flat	1916	103	--
e/ 21	do.	Sec. 45, NW $\frac{1}{2}$ NE $\frac{1}{4}$	do.	S. E. Axtell	--	Slope	--	48	--
e/ 24	9 miles west	Sec. 44, NW $\frac{1}{2}$ SE $\frac{1}{4}$	do.	C. E. Pochel	A. B. Hayes	do.	1931	100	18
26	7 $\frac{1}{2}$ miles west	Sec. 55, SW $\frac{1}{2}$ SW $\frac{1}{4}$	do.	Halsell Cattle Co.	--	do.	--	--	--
e/ 28	8 $\frac{1}{2}$ miles west	Sec. 43, NW cor., NW $\frac{1}{2}$	do.	J. M. Young	W. M. Slaughter	Flat	--	--	--
e/ 29	9 miles west	Sec. 38, NW cor., NW $\frac{1}{4}$	do.	E. R. Hart	John Kropff	do.	--	--	--
e/ 30	8 miles west	Sec. 38, E. side, NE $\frac{1}{2}$ SE $\frac{1}{4}$	do.	J. M. Young	--	do.	--	45	15
e/ 31	do.	Sec. 43, NW $\frac{1}{2}$ NE $\frac{1}{4}$ NE $\frac{1}{4}$	do.	Fred Smoker	--	do.	1935	--	--
33	6 $\frac{1}{2}$ miles west	Sec. 57, SW $\frac{1}{4}$ Sec. 72, NW $\frac{1}{4}$	do.	Halsell Cattle Co.	--	do.	--	Spring	--
36	do.	Sec. 56, NE $\frac{1}{2}$ NW $\frac{1}{2}$ SW $\frac{1}{4}$	blk. 2	Herman Harberer	-- Cook	Slope	1936	165	12
37	7 miles northwest	Sec. 40, SW $\frac{1}{2}$ SE $\frac{1}{4}$	W.E. Halsell subdv, blk. 2	Cleve Hamilton	-- Mc-Donald	Flat	1928	83	5-3/16
e/ 38	5 $\frac{1}{2}$ miles west	Sec. 57, SE $\frac{1}{2}$ NE $\frac{1}{4}$ NE $\frac{1}{4}$	blk. 2	Zeb Smith Halsell Cattle Co.	do.	Rolling	1931	70	15
40	5 miles west	Sec. 73, NE $\frac{1}{4}$	Halsell subdv, blk. 2	Halsell Cattle Co.	--	Flat	--	Spring	--
e/ 41	4 $\frac{3}{4}$ miles west	Sec. 74, NE $\frac{1}{2}$ NW $\frac{1}{2}$ NW $\frac{1}{4}$	do.	do.	D. B. Gano	do.	1921	100	--

W. L. Broadhurst, Project Superintendent

No.	Height of measuring point above ground (ft.) _{a/b/}	Water Level		Pump and power c/	Use of water d/	Remarks
		Depth below measuring point (ft.)	Date of measurement			
16	0.2	37.7	May 6, 1936 f/	Cf,G, 35	I	Reported 23 feet drawdown pumping 815 gallons a minute. Reported irrigates 140 acres. See log.
		36.4	Jan. 25, 1937			
		36.9	June 24, 1937			
17	0.5	62.8	Feb. 4, 1937	C,W	S	Steel casing.
19	-17.8	2	Oct. 30, 1936 f/	Cf,Tr, 20	I	Reported 14 to 15 feet drawdown pumping 980 gallons a minute. Reported irrigates 80 acres. Pump operated 200 hours in 1936.
		1.8	Jan. 26, 1937			
21	-12	5.8	Nov. 10, 1936	Cf,Tr, --	I	
		5.7	Jan. 26, 1937			
24	0	15	Feb. 4, 1937	T,G,30	S	Reported water level, 13 feet when drilled. Reported yield, 2,000 gallons a minute.
26	--	--	--	C,W	S	No casing.
28	0.3	18.9	Oct. 26, 1936 f/	T,Tr, 50	I	Reported 37 feet drawdown after pumping 1,200 gallons a minute for 12 hours. Reported irrigates 75 acres. Reported pump operated 300 hours in 1936.
		18	Jan. 26, 1937			
29	1	31.7	Jan. 27, 1937	Cf,Tr, 15	I	No casing. Dug well. Reported yield, 700 gallons a minute. Reported irrigates 65 acres.
30	0	24.5	Oct. 28, 1936 f/	T,G,30	I	Steel casing. Reported irrigates 1936.
		23.7	Feb. 4, 1937			
31	0.5	18.2	Oct. 28, 1936	T,G,20	I	No casing. Reported yield, 700 gallons a minute. Reported irrigates 130 acres. Pump operated 500 hours in 1936.
		18	Feb. 4, 1937			
33	--	Flows	Mar. 16, 1937	None	N	Water reported from several openings in sand and alkali. Reported fails in drought.
36	1.5	50.8	Oct. 28, 1936	T,G,30	I	Cylinder set at 108 feet; 10 feet of suction; can draw down below suction pipe. Estimated yield, 950 gallons a minute. Reported irrigates 160 acres. Pump operated 470 hours in 1936.
		50.7	Feb. 4, 1937			
37	0.8	73.7	do.	C,W	D,S	Water reported in sand.
38	0.8	40.8	Oct. 28, 1936	T,G,42	I	Water reported from hard gravel and clay at 60 to 90 feet, coarse sand and gravel at 90 to 120 feet. Reported 25 feet drawdown pumping 775 gallons a minute. Reported irrigates 100 acres. Pump operated 792 hours in 1936.
		40	Feb. 4, 1937			
40	--	Flows	Mar. 16, 1937	None	S	Water reported from several openings in sand wash in bed of draw.
41	---	20	g/	Cf,G, 25	I	Reported yield, 800 gallons a minute. Reported irrigates 20 acres. Pump operated 300 hours in 1936.

Byron Lockman 78
Top Son C. 621

8-9-38 Pumping 96 hrs

Records of wells and springs in Lamb County--Continued

No.	Distance from Earth	Section or Labor	Survey, Block or League	Owner	Driller	Topographic situation	Date completed	Depth of well (ft.)	Diameter of well (in.)
42	4½ miles west	Sec. 74, SE¼NW¼	Halsell subdv, blk. 2	Halsell Cattle Co.	--	Slope	--	21	--
43	4 miles southwest	Sec. 6, SW¼SW¼	J.H. Stephens, blk. S-2	do.	--	Flat	--	45	--
44	5 miles northwest	Sec. 38, SE¼SE¼	Halsell subdv, blk. 2	Cleve Hamilton	-- Mc-Donald	Slope	1928	142	4½
45	3½ miles northwest	Sec. 60, NW¼NE¼NW¼	do.	Halsell Cattle Co.	--	Rolling	--	90	4½
46	1½ miles west	Sec. 68, SW¼SW¼	do.	L. C. Haliburton	-- Mc-Donald	Slope	1934	71	6
47	5 miles north	Sec. 30, SE¼SW¼	do.	W. A. McCord	--	--	1929	131	4½
48	1½ miles north	Sec. 62, NE cor. SE¼	do.	J. W. Kelley	--	Flat	1915	108	4
49	1 mile south	Sec. 82, NW¼NW¼	do.	James Duffy	--	Edge of dry lake	1929	79	4
50	2 miles east	Sec. 80, NE¼NE¼	do.	W. D. Howard	W. D. Howard	--	1929	101	5
e/ 51	2½ miles northeast	Sec. 72, NW¼NW¼	Halsell subdv, blk. 1	R. F. Jackson	D. F. McDonald	Edge of lake	1937	92	4
52	3 miles northeast	Sec. 57, SW¼NE¼	do.	J. F. Kelley	-- Peerless	Slope	1936	180	16
e/ 52a	3½ miles northeast	Sec. 57, NE¼NE¼	do.	Springlake School	--	Flat	1925	100	5
53	5½ miles northeast	Sec. 40, NW¼NW¼	do.	J. D. Nix	John Whitfield	Slope	1936	200	--
e/ 54	6 miles northeast	Sec. 39, NW¼NW¼	do.	-- Wilson R.G.	Bradford Supply Co.	do.	1937	190	15½
e/ 55	8 miles northeast	Sec. 28, SE¼SE¼	do.	--	--	do.	--	94	--
e/ 56	6 miles northeast	Sec. 53, SE¼NW¼	do.	N. F. Cleavinger	Bradford Supply Co.	do.	1937	215	15½
57	5 miles northeast	Sec. 59, NW¼NE¼	do.	E. E. Gettis	-- Sawyer	do.	1937	224	14
58	4¼ miles east	Sec. 20, SE¼SW¼	do.	W. H. Skinner	--	do.	--	84	--
e/ 59	5½ miles east	Sec. 2, E¼W¼	blk. S-2	A. J. Young	--	--	1936	190	--
60	do.	Sec. 69, NW¼SE¼	Halsell subdv, blk. 1	S. A. Davis	Bradford Supply Co.	Gentle slope	1937	220	15½
e/ 61	17 miles east	Sec. 4, SW¼NW¼	blk. MO	Ralph Roper	--	do.	1937	--	--
e/ 62	do.	Sec. 6, NW¼SE¼	blk. JB	J. M. Dye	-- West	do.	1937	182	16
e/ 63	17½ miles east	Sec. 22, NE¼NW¼	blk. S-1	-- Kiser	Green Bros.	do.	1937	185	--
e/ 64	18½ miles east	Sec. 14, NW¼NW¼	blk. O2	J. A. Ragle	-- West	do.	1937	180	16
e/ 65	18 miles east	Sec. 14, NW¼SW¼	do.	H. A. Bledsoe	-- Cook	do.	1934	204	14

W. L. Broadhurst, Project Superintendent

No.	Height of measuring point above ground (ft.) _{a/b/}	Water Level		Pump and power <u>c/</u>	Use of water <u>d/</u>	Remarks
		Depth below measuring point (ft.)	Date of measurement			
42	0.3	19.3	Feb. 5, 1937	None	N	
		18.2	June 24, 1937			
43	1	26	Feb. 10, 1937	C,W	S	Water reported from sand.
44	0.7	91	Feb. 4, 1937	C,W	D,S	
45	3	71.8	Feb. 10, 1937	C,W	D,S	Steel casing.
46	0.8	39.7	Feb. 5, 1937	C,W	D,S	Do.
47	2	88.9	do.	C,W	D,S	Do.
48	1.4	62.9	do.	C,W	D,S	Galvanized iron casing.
49	2	--	--	C,W	D,S	
50	0.7	58.7	Apr. 6, 1937	C,W	D,S,I	First water reported at 65 feet.
51	1	61.6	do.	--	D,S	Steel casing. See log.
52	--	70	<u>f/</u>	T,G,20	I	Steel casing.
52a	0.4	86.3	Oct. 7, 1937	C,W	P,I	Reported weak supply.
53	--	--	--	Cf,G, --	I	Temperature, 63° F.
54	1	88.4	Apr. 1, 1937	--	I	Concrete curb; steel casing.
<i>Top Pump</i> <i>55</i>	<i>1.2</i>	<i>90.92</i>	--	C,H	D,S	<i>110 setting 2 1/2 in. 20 suction</i> Reported dry when observed.
<i>f 20</i>	--	<i>76.74</i> <i>2.3</i>	--	C,G,12	I	Steel casing.
57	--	80	<u>f/</u>	T,G,80	I	Steel casing. Temperature, 63° F.
58	0.4	76	Apr. 6, 1937	C,W	D,S	Reported irrigates small garden in summer.
59	--	--	--	--	I	
60	1.5	70.6	June 24, 1937	C,G,85	I	Reported 28 feet drawdown after pumping two hours.
61	1.7	78.1	May 27, 1937	C,G,85	I	
62	1.5	62.5	do.	C,G,85	I	Reported pump set at 110 feet with 25 feet of 9-inch suction pipe.
63	1.5	68.5	do.	C,G,85	I	
64	1	81.5	do.	T,D,50	I	Reported pump set at 110 feet with 10 feet of 8-inch suction pipe.
65	1	77.9	May 28, 1937	T,G,85	I	Steel casing.

Records of wells and springs in Lamb County--Continued

No.	Distance from Earth	Section or Labor	Survey, Block or League	Owner	Driller	Topographic situation	Date completed	Depth of well (ft.)	Diameter of well (in.)
66	18 $\frac{1}{2}$ miles east	Sec. 22, SW $\frac{1}{4}$ SE $\frac{1}{4}$	blk. 02	G. C. Crosby	--	Gentle slope	--	97	--
e/ 67	19 miles east	Sec. 20, SW $\frac{1}{4}$ NE $\frac{1}{4}$	do.	--	--	do.	--	--	--
68	19 miles southeast	Sec. 19, SW $\frac{1}{4}$ SW $\frac{1}{4}$	do.	W. B. Eby	Ray Mullins	do.	1937	202	16
e/ 69	18 miles southeast	Sec. 5, SW $\frac{1}{4}$ SE $\frac{1}{4}$	blk. B	L. L. George	L. B. West	Edge of sand hills	1936	177	18
e/ 70	17 $\frac{1}{2}$ miles southeast	Sec. 5, SW $\frac{1}{4}$ NE $\frac{1}{4}$	do.	F. L. Thurman	-- Green	do.	1936	190	18
e/ 71	17 $\frac{1}{2}$ miles east	Sec. 29, NW $\frac{1}{4}$ NW $\frac{1}{4}$	blk. 02	A. S. Natzger	L. B. West	Gentle slope	1937	170	16
e/ 72	14 $\frac{1}{2}$ miles southeast	Sec. 20, NE $\frac{1}{4}$ NW $\frac{1}{4}$	blk. 05	E. N. Burrus	do.	do.	1936	182	15
e/ 73	13 $\frac{1}{2}$ miles east	Sec. 16, NE $\frac{1}{4}$ NW $\frac{1}{4}$	do.	G. T. Galloway	-- Patton	do.	1937	200	13
e/ 76	10 miles east	Sec. 12, NW $\frac{1}{4}$ NE $\frac{1}{4}$	blk. T-1	F. E. Gladden	do.	do.	1937	220	15 $\frac{1}{2}$
e/ 77	8 $\frac{1}{2}$ miles southeast	Sec. 15, NW $\frac{1}{4}$ NE $\frac{1}{4}$	do.	Doyle W. Pinsen	George Garms	Near small lake	--	126	15 $\frac{1}{2}$
78	8 miles southeast	Sec. 15, NW $\frac{1}{4}$ SW $\frac{1}{4}$	do.	W. O. Roebuck	-- Cook	Gentle slope	1936	175	16
79	do.	Sec. 16, cen. E $\frac{1}{2}$	do.	Ada L. Crawford	-- West	do.	1936	183	16
e/ 81	9 $\frac{1}{2}$ miles southeast	Sec. 27, SW $\frac{1}{4}$	do.	--	--	Sand hills	--	89	4 $\frac{1}{2}$
83	10 $\frac{1}{2}$ miles southeast	Sec. 39, SW $\frac{1}{4}$ SW $\frac{1}{4}$	do.	Halsell Cattle Co.	--	do.	--	59	7 $\frac{1}{2}$
84	6 $\frac{1}{2}$ miles southeast	Lab. 10, NE $\frac{1}{4}$	Lge. 243	do.	--	do.	--	46	4 $\frac{1}{2}$
85	3 $\frac{1}{2}$ miles southeast	Lab. 1, NW $\frac{1}{4}$ NE $\frac{1}{4}$	Lge. 242	J. B. Northcott	-- Halsell	Rolling	1930	70	4
86	5 miles southeast	Lab. 8, NW $\frac{1}{4}$ NW $\frac{1}{4}$	Lge. 243	B. F. Redwine	--	Sand dunes	--	78	4
87	9 miles south	Lab. 23, SE $\frac{1}{4}$	Lge. 239	Matt Nix	--	Rolling	1927	71	4 $\frac{1}{2}$
88	8 $\frac{1}{2}$ miles south	Lab. 20, SW $\frac{1}{4}$	Lge. 238	Halsell Cattle Co.	--	Edge of sand hills	--	42	4
89	6 $\frac{1}{2}$ miles south	Lab. 22, SW $\frac{1}{4}$	Lge. 237	do.	--	Sand flat	--	20	4 $\frac{1}{2}$
90	4 $\frac{1}{2}$ miles south	Lab. 9, NE $\frac{1}{4}$	do.	do.	--	Sand dunes	--	39	6
e/ 91	2 miles south	Lab. 5, NE $\frac{1}{4}$ NW $\frac{1}{4}$	Lge. 241	do.	-- McDonald	Gentle slope	1925	125	--
92	2 $\frac{1}{2}$ miles southwest	Lab. 8, NE $\frac{1}{4}$	do.	do.	--	Flat	--	--	5- 3/16
93	5 $\frac{1}{2}$ miles southwest	Lab. 10, NW $\frac{1}{4}$	Lge. 234	do.	--	In sand hills	--	33	5- 3/16
94	9 miles south	Lab. 22, NE $\frac{1}{4}$	Lge. 233	-- Moore	--	Hilltop	--	82	4
96	9 $\frac{1}{2}$ miles southwest	Lab. 10, SE $\frac{1}{4}$	Lge. 222	Dallas Bank & Trust Co.	--	Ridge-top	--	58	--

W. L. Broadhurst, Project Superintendent

No.	Height of measuring point above ground (ft.) _{a/b/}	Water Level		Pump and power c/	Use of water d/	Remarks
		Depth below measuring point (ft.)	Date of measurement			
66	0.5	82.1	Apr. 8, 1937	C,W	D,S	Concrete curb. Reported irrigates small garden in summer.
		82.1	Oct. 5, 1937			
67	2.5	66.8	May 28, 1937	T,G,87	I	Concrete curb.
68	2.5	64.9	do.	C,G,85	I	Steel casing. Temperature, 62° F.
69	3.5	69.1	do.	T,G,85	I	Steel casing.
70	1	67.8	do.	C,G,85	I	Reported irrigated 100 acres during 1936.
71	1	63.2	do.	T,G,85	I	Steel casing.
72	1.5	71.6	do.	T,G,85	I	Do.
73	1.3	67.4	do.	T,G,85	I	Do.
76	1	77.3	June 24, 1937	T,G,50	I	Reported 21.2 feet drawdown after pumping 800 gallons a minute for 3 hours.
77	1.4	59.3	Apr. 1, 1937	T,G,70	I	Concrete curb; steel casing.
78	2.2	58.8	Oct. 5, 1937	T,G,40	I	Steel casing. Reported pumped continuously 17 days and nights in 1936.
79	--	--	--	T,G,85	I	Steel casing. Reported pumped 800 gallons a minute for 21 days and nights in 1936.
81	1	58.6	Mar. 27, 1937	C,W	S	Steel casing. Reported strong supply.
83	1	54.3	Mar. 30, 1937	C,W	S	Do.
84	--	46	f/	C,W	S	Do.
85	0.8	44.8	Mar. 16, 1937	C,W	D,S	Wood curb; steel casing. Reported irrigates small garden.
86	1.5	74.6	do.	C,W	D,S	Galvanized casing.
87	1	59.6	Feb. 23, 1937	C,W	D,S	Wood curb; steel casing. Reported irrigates small garden.
88	0	38.6	do.	C,W	S	Tin casing.
89	1	10.3	do.	C,W	S	Steel casing.
90	2.5	25.7	Mar. 16, 1937	C,W	S	Do.
91	--	--	--	Cf,--	N	Caved in.
92	--	--	--	C,W	S	Steel casing.
93	1	27.4	Feb. 10, 1937	C,W	S	Steel casing. Strong supply reported in sand.
94	1	56.9	Feb. 23, 1937	C,W	D,S	Wood curb; tin casing.
96	0	41.7	Feb. 9, 1937	C,H	D,S	Wood curb. Water reported in sand.

Records of wells and springs in Lamb County--Continued

No.	Distance from Earth	Section or Labor	Survey, Block or League	Owner	Driller	Topographic situation	Date completed	Depth of well (ft.)	Diameter of well (in.)
98	8 miles southwest	Lab. 12, NE $\frac{1}{4}$	Lge. 221	Halsell Cattle Co.	--	Sand dunes	1934	46	5- $\frac{3}{16}$
101	7 miles west	Lab. 2, cen.	Sur. 236	do.	--	do.	--	53	--
102	10 miles southwest	Lab. 2, SE $\frac{1}{4}$	Lge. 219	do.	--	Flat	--	45	8
103	11 miles southwest	Lab. 6, SW $\frac{1}{4}$	Lge. 222	T. H. White	T. H. White	Gentle slope	1928	73	4
105	13 miles southwest	Lab. 15, NE $\frac{1}{4}$	Lge. 218	Sam Sanders	do.	Rolling	1929	109	--
e/107	10 $\frac{1}{2}$ miles west	do.	Lge. 220	Janes Est.	--	do.	--	18	4 $\frac{1}{2}$

No.	Distance from Littlefield	Section or Labor	Survey, Block or League	Owner	Driller	Topographic situation	Date completed	Depth of well (ft.)	Diameter of well (in.)
201	19 $\frac{1}{2}$ miles northwest	Lab. 10, SE $\frac{1}{4}$	Lge. 208	U. B. Porter	--	Edge of dry lake	Old	114	5- $\frac{3}{16}$
204	16 miles west	Lab. 15, SE $\frac{1}{4}$ NE $\frac{1}{4}$	Lge. 215	L. R. Capps	-- Mc-Carty	Gentle slope	1923	160	4 $\frac{1}{2}$
e/205	16 $\frac{1}{2}$ miles west	Lab. 9, NE $\frac{1}{4}$	Lge. 211	John E. Case	Guy Blevins	Ridge-top	1937	192	4
206	do.	Lab. 12, SE $\frac{1}{4}$	do.	Case Bros.	Zar Nordyke	Edge of dry lake	1928	248	4 $\frac{1}{2}$
207	15 miles west	Lab. 16, NE $\frac{1}{4}$	Lge. 213	J. C. Whaley	-- White	Hill-side	1929	250	5- $\frac{3}{16}$
208	12 $\frac{1}{2}$ miles west	Lab. 6, SW $\frac{1}{4}$	Lge. 227	S. O. Wakeman	--	Flat	--	145	4 $\frac{1}{2}$
209	13 $\frac{1}{2}$ miles west	Lab. 21, SW $\frac{1}{4}$ SE $\frac{1}{4}$	Lge. 215	J. B. Wingo	-- Quaw	Rolling	1925	202	--
210	15 miles northwest	Lab. 21, NE $\frac{1}{4}$ SE $\frac{1}{4}$	Lge. 216	R. N. Triplett	Jones Bros.	Edge of dry lake	1920	139	--
211	17 $\frac{1}{2}$ miles northwest	Lab. 23, SW $\frac{1}{4}$	Lge. 217	Sudan Cemetery	-- White	Ridge-top	1937	198	4 $\frac{1}{2}$
212	18 miles northwest	Lab. 9, NE $\frac{1}{4}$	do.	R. M. Jones	-- Mc-Carty	Gentle slope	1926	99	4
e/215	16 miles northwest	Lab. 9, SE $\frac{1}{4}$	Lge. 223	Joe West	do.	do.	1922	70	4
216	15 miles northwest	Lots 1 & 2	blk.42, City of Sudan	R. M. Grissom	-- White	Flat	1925	117	4 $\frac{1}{2}$
217	do.	Lab. 23, S $\frac{1}{2}$	Lge. 223	City of Sudan	H. J. McCarty	do.	1935	134	10
217a	do.	do.	do.	do.	--	do.	--	134	--
220	12 $\frac{1}{2}$ miles northwest	Lab. 9, SE $\frac{1}{4}$	Lge. 225	F. C. Whiteside	--	Gentle slope	Old	108	6
221	12 miles northwest	Lab. 11, NW $\frac{1}{4}$	do.	A. W. Phillips	-- Foust	do.	1936	126	4 $\frac{1}{2}$

a/ Measuring point was usually top of casing, top of pump base, or top of well curb.
 b/ Measuring point above ground unless below ground indicated by minus (-) sign.
 c/ C, cylinder; T, turbine; Cf, centrifugal; W, windmill; G, gasoline engine; E, electric motor; Tr, tractor; D, diesel; H, hand; B, bucket or bailer; number indicates horsepower.

W. L. Broadhurst, Project Superintendent

No.	Height of measuring point above ground (ft.) a/b/	Water Level		Pump and power c/	Use of water d/	Remarks
		Depth below measuring point (ft.)	Date of measurement			
98	2	34	Feb. 9, 1937	C,W	S	Steel casing. North well of two wells.
101	0.8	32.1	do.	C,W	S	Wood curb. Reported weak supply.
102	2.5	29.4	do.	C,W	S	Steel casing. Reported strong supply.
103	0.3	56.1	Feb. 24, 1937	C,W	D,S	Wood curb; galvanized casing. Water reported in white sand.
105	0.8	88.2	Feb. 11, 1937	C,W	D,S	Concrete curb. Reported irrigates small garden.
107	0	13.4	Mar. 6, 1937	C,W	S	Wood curb; steel casing.
No.	Height of measuring point above ground (ft.) a/b/	Depth below measuring point (ft.)	Date of measurement	Pump and power c/	Use of water d/	Remarks
201	1.5	107.3	Feb. 11, 1937	C,W	D,S	Wood curb; steel casing. Reported weak supply.
204	0.8	151.1	Mar. 12, 1937	C,W	D,S	Wood curb; steel casing. Reported strong supply.
205	0.8	168.4	Feb. 27, 1937	C,W	D,S	New well.
206	1	234.4	do.	C,W	D,S	Water reported in sand below blue clay and above "Red Beds."
207	--	--	--	C,W	D,S	Steel casing. Reported strong supply.
208	0.4	105.2	Mar. 11, 1937	C,W	D,S	Wood curb.
209	0.3	99.2	Feb. 25, 1937	C,W	D,S	Wood curb. Weak supply reported in sand and gravel at 100 to 102 feet.
210	1	123.1	Feb. 24, 1937	C,W	D,S	Wood curb; no casing. Strong supply reported in sandstone at 142 feet.
211	0.7	146.6	do.	C,W	D,I	Steel casing.
212	0	83	Feb. 11, 1937	C,W	D,S	Tin casing. Reported irrigates small garden.
215	1.3	63.1	Feb. 8, 1937	C,W	D,S	Galvanized casing. Reported strong supply.
216	1	102.5	Mar. 11, 1937	C,W	D,S	Wood curb. Reported irrigates small garden.
217	--	--	--	T,E,40	P	Steel casing. One of 5 city wells.
217a	--	--	--	--	--	Do.
220	0.9	101.1	Mar. 11, 1937	C,W	D,S	Steel casing.
221	2.5	103.1	do.	C,W	D,S	Steel casing. Strong supply reported in sand and quartz gravel at 124 to 130 feet.

a/ D, domestic; S, stock; I, irrigation; P, public; N, not used.

b/ No water sample collected for a alysis.

c/ Water level reported.

Records of wells and springs in Lamb County--Continued

No.	Distance from Littlefield	Section or Labor	Survey, Block or League	Owner	Driller	Topographic situation	Date completed	Depth of well (ft.)	Diameter of well (in.)
222	11½ miles west	Lab. 12, NE¼	Lge. 228	T. M. Young	--	Gentle slope	1915	82	--
223	8 miles west	Lab. 20, SE¼	Lge. 229	--	--	do.	--	65	4½
e/224	10 miles northwest	Lab. 23, SE¼	Lge. 230	--	--	Edge of Old dry lake		86	--
e/225	10½ miles northwest	Lab. 13, SE¼	do.	H. L. Messamore	-- White	do.	1937	100	4½
226	11½ miles northwest	Lab. 22, NW¼	Lge. 231	B. R. Haney	do.	Gentle slope	1929	220	4½
e/228	12½ miles northwest	Sec. 1, S½	blk. S-1	--	--	Sand dunes	--	78	4½
e/230	6½ miles northwest	Sec. 3, S½	do.	--	--	Rolling	--	130	--
e/231	17 miles northwest	Lab. --, NE¼	Lge. 217	Vincent Peterman	--	Gentle slope	1937	136	4½
232	7 miles northwest	Lab. 7, SE¼	Lge. 661	Harris Brantley	--	do.	1927	87	--
233	6 miles west	Lab. 13, SW¼	Lge. 662	L. M. Brandon	--	do.	Old	79	6
234	4½ miles northwest	Lab. 17, SW¼	Lge. 660	Fred Kraushar	T. P. Wright	do.	1929	98	4½
235	7½ miles northwest	Lab. 11, NW¼	Lge. 648	City of Amherst	J. M. hitfield	--	1936	210	12½
e/236	9 miles northwest	Lab. 24, SE¼	Lge. 649	L. D. Criswell	do.	Hilltop	1936	135	15½
237	10 miles northwest	Lab. 13, SW¼	Lge. 647	J. E. Smith	--	Gentle slope	1934	181	5-3/16
238	12 miles northwest	Lab. 16, SE¼	Lge. 633	W. H. Priddy	--	--	1930	61	4½
239	9 miles northwest	Lab. 14, SE¼	Lge. 645	Odus Moore	-- Whitfield	Rolling	1935	200	4½
e/240	7½ miles north	Lab. 22, SE¼	do.	C. V. Harmon	C. V. Harmon	do.	1937	210	16
241	5 miles north	Lab. 25, SE¼	Lge. 650	O. E. Sumner	--	--	1925	66	--
e/242	3 miles northwest	Lab. 21, NE¼	Lge. 660	-- Edwards	--	Gentle slope	--	121	--
e/243	2½ miles northwest	Lab. 5, cen.	Lge. 664	Les Barker	Les Barker	Edge of lake	1936	130	14
e/247	1½ miles northwest	Lab. 7, NE¼	do.	A. D. Kelley	A. D. Hays	do.	1926	175	--
248	2¼ miles north	Lab. 17, SE¼	Lge. 659	S. B. Pinkerton	--	Gentle slope	--	92	4½
249	10½ miles north	Lab. 21, NW¼	Lge. 634	Mrs. Effie Tatum	--	Side of draw	1925	87	4½
250	11 miles north	Lab. 12, SW¼	Lge. 635	M. A. Parmer	-- Whitfield	do.	1934	158	5½
251	8½ miles north	Lab. 13, SE¼	Lge. 644	--	--	Sand dunes	--	80	4½
e/252	5½ miles north	Lab. 20, NE¼	Lge. 650	Henry Sager	Fred Foust	Ridge-top	1936	200	16

W. L. Broa urst, Project Superintendent

No.	Height of measuring point above ground (ft.) _{a/b/}	Water Level		Pump and power <u>c/</u>	Use of water <u>d/</u>	Remarks
		Depth below measuring point (ft.)	Date of measurement			
222	--	68.7	f/	C,W	D,S	Wood curb; no casing. Reported strong supply.
223	1.5	43.9	Mar. 9, 1937	C,W	D,S	
224	0.5	77.9	Feb. 24, 1937	C,W	S	Wood curb.
225	0.8	80.3	do.	--	D,S	Steel casing. Water reported in limy sand.
226	--	--	--	C,W	D,S	Steel casing. Reported irrigates small garden.
228	1.5	57.9	Feb. 23, 1937	C,W	D,S	
230	0.3	91.1	June 25, 1937	C,H	D	Wood curb.
231	1	97.1	do.	B,H	D	Steel casing.
232	1.2	73.8	Mar. 9, 1937	C,W	D,S	Wood curb. Reported irrigates small garden.
233	0.4	61.9	do.	C,W	D,S	Wood curb; steel casing. Reported irrigates small garden.
234	0.6	86.6	Mar. 22, 1937	C,W	D,S	Do.
235	--	80	f/	T,E,25	P	Steel casing.
236	--	72	f/	T,G,60	I	Steel casing. Water reported in sand at 78 feet.
237	2	71.2	Mar. 9, 1937	C,W	D,S	Wood curb; steel casing. Reported irrigates small garden.
238	0.5	49.2	Feb. 23, 1937	C,W	D,S	Steel casing. Reported irrigates small garden.
239	1.8	79.7	Mar. 8, 1937	C,W	D,S	Wood curb. Reported strong supply.
240	1	77.9	do.	T,G,60	I	Steel casing. Water reported in white sand at 82 to 210 feet.
241	0.8	61.8	Mar. 22, 1937	C,W	D,S	Wood curb. Reported strong supply.
242	0	84.8	June 25, 1937	None	N	
243	1	79.1	do.	T,G,40	I	Concrete curb; steel casing, 0 to 20 feet.
247	0.3	68.3	do.	T,G,40	I	Supplies swimming pool.
248	3	74.6	Mar. 22, 1937	C,W	D,S	Steel casing. Reported irrigates small garden.
		74.5	Oct. 6, 1937			
249	1.2	54.9	Mar. 10, 1937	C,W	D,S	Do.
250	0.4	58.9	do.	C,W	D,S	Do.
251	--	75.8	f/	C,W	D,S	Steel casing.
252	1.7	75.8	Mar. 27, 1937	T,G,60	I	Steel casing. Strong supply reported in sand at 190 to 198 feet.

Records of wells and springs in Lamb County--Continued

No.	Distance from Littlefield	Section or Labor	Survey, Block or League	Owner	Driller	Topographic situation	Date completed	Depth of well (ft.)	Diameter of well (in.)
256	1 $\frac{1}{4}$ miles north	Lab. 1, cen.	Lge. 664	C. R. Spann	-- Bartley	Rolling	1937	204	16
e/257	2 miles northeast	Lab. 5, NW $\frac{1}{4}$	Lge. 665	--	--	Flat	--	135	--
e/258	do.	Lab. 4, SW $\frac{1}{4}$	do.	A. F. Jones	-- Green	Rolling	<i>old</i>	--	--
260	10 $\frac{1}{2}$ miles north	Lab. 18, SW $\frac{1}{4}$	Lge. 636	C. L. Rogers	Fred Foust	do.	1936	186	15 $\frac{1}{2}$
266	6 $\frac{1}{2}$ miles northeast	Lab. 10, SW $\frac{1}{4}$	Lge. 657	J. J. Harlan	John Carey	do.	1925	126	4 $\frac{1}{2}$
e/268	8 miles northeast	Sec. 70, SW $\frac{1}{4}$ NE $\frac{1}{4}$	blk. T, T.A.T. sur.	H. C. Pickrell	--	Gentle slope	--	--	--
271	9 $\frac{1}{2}$ miles northeast	Lab. 19, NW $\frac{1}{4}$	Lge. 642	Eva Wells	-- Whitfield	do.	1937	193	16
e/272	10 miles northeast	Lab. 12, NW $\frac{1}{4}$	do.	-- Box	--	do.	1937	--	--
e/273	do.	Lab. 11, SW $\frac{1}{4}$	do.	H. C. Pickrell	--	do.	--	--	--
e/274	do.	Lab. 20, NW $\frac{1}{4}$	do.	C. E. Pickrell	-- Whitfield	do.	--	--	--
e/274a	do.	Lab. 20, NE $\frac{1}{4}$	do.	Fieldton School	Buck Elliott	Flat	1928	96	5
275	9 miles northeast	Sec. 35, SW $\frac{1}{4}$ SW $\frac{1}{4}$	blk. T, T.A.T. sur.	H. C. Green	-- Whitfield	do.	1937	160	15 $\frac{1}{2}$
276	9 miles east	Sec. 47, SW $\frac{1}{4}$ SW $\frac{1}{4}$	do.	-- Bennett	--	Rolling	--	126	--
277	9 $\frac{1}{2}$ miles northeast	Sec. 45, NE $\frac{1}{4}$ NE $\frac{1}{4}$	do.	B. A. Ball	--	--	--	104	4 $\frac{1}{2}$
278	11 miles northeast	Sec. 33, SW $\frac{1}{4}$ NW $\frac{1}{4}$	do.	L. T. Green	L. T. Green	Gentle slope	1936	150	16
e/279	15 $\frac{1}{2}$ miles northeast	Sec. 8, N $\frac{1}{2}$ SE $\frac{1}{4}$	do.	Elwood Est.	-- West	Sand hills	1933	80	--
e/280	9 $\frac{1}{2}$ miles east	Sec. 53, SW $\frac{1}{4}$ SW $\frac{1}{4}$	do.	G. V. Coker	A. B. Hayes	Rolling	1936	202	16
e/281	10 $\frac{1}{2}$ miles east	Sec. 64, SW $\frac{1}{4}$ SW $\frac{1}{4}$	do.	Mrs. H. Ramage	-- Paten	do.	1936	195	14
282	11 miles northeast	Sec. 43, SE $\frac{1}{4}$ SE $\frac{1}{4}$	do.	J. J. M. Sanders	-- Foust	Gentle slope	1930	138	4 $\frac{1}{2}$
e/283	12 miles northeast	Sec. 40, SW $\frac{1}{4}$ NE $\frac{1}{4}$	do.	Henry P. Price	Henry P. Price	do.	1936	114	--
e/284	14 miles northeast	Sec. 30, NE $\frac{1}{4}$ SW $\frac{1}{4}$	do.	Swan J. Huff	-- For-gason	do.	1937	151+	--
285	13 miles northeast	SE $\frac{1}{4}$ SW $\frac{1}{4}$ SW $\frac{1}{4}$	Sur. 156, Elwood subdv.	S. C. Tolbert and sons	-- Foust	do.	1936	126	15
e/286	12 $\frac{1}{2}$ miles east	Sec. 41, SW $\frac{1}{4}$ SE $\frac{1}{4}$	blk. T, T.A.T. sur.	J. R. Coen	-- Sawyer	do.	1937	100	14
287	12 miles east	Sec. 62, NW $\frac{1}{4}$ NE $\frac{1}{4}$	do.	J. P. Barker	-- Mor-gan	do.	1930	91	4 $\frac{1}{2}$
e/288	13 $\frac{1}{2}$ miles northeast	Sec. 71, E $\frac{1}{2}$ S $\frac{1}{2}$	do.	--	--	do.	--	88	--
289	14 $\frac{1}{2}$ miles northeast	Sec. 1, NW $\frac{1}{4}$ SE $\frac{1}{4}$	blk. B, Elwood subdv.	Elwood Estate	--	Edge of creek	1933	19	--

W. L. Broadhurst, Project Superintendent

No.	Height of measuring point above ground (ft.) _{a/b/}	Water Level		Pump and power _{c/}	Use of water _{d/}	Remarks
		Depth below measuring point (ft.)	Date of measurement			
256	1.5	84	f/	Cf,G, 50	I	Steel casing. Water reported in fine-grained, red sand.
257	0.5	56.2	Apr. 28, 1937	None	N	Nearest pumping well, $\frac{1}{4}$ mile southwest.
258	2	63.8	do.	T,G,50	I	Concrete curb. Reported strong supply.
260	--	78	f/	T,G,50	I	
266	3	99.4	Apr. 9, 1937	C,W	D,S	Steel casing. Reported irrigates small garden.
268	1	98.3	Mar. 10, 1937	T,G,50	I	
271	--	--	--	T,G,50	I	Steel casing. Water reported in sand and gravel.
272	--	--	--	--	--	
273	--	--	--	--	--	
274	--	--	--	--	--	
274a	--	--	--	C,W	P	Reported strong supply.
275	1.5	86.4	Apr. 1, 1937	T,G,60	I	Steel casing. Reported 18.2 feet drawdown after pumping 650 gallons a minute for 6
276	0.9	100.9	Apr. 9, 1937	C,W	D,S	Wood curb. Reported irrigates garden and vineyard. hours.
277	1	84.3	Apr. 14, 1937	C,W	D,S	Steel casing. Reported strong supply.
278	--	75	f/	T,G,50	I	Do.
279	--	--	--	--	D,S,I	Do.
280	--	100	f/	T,G,85	I	Steel casing. Reported pumped 1,200 gallons a minute for 268 hours.
281	1	105.9	Apr. 9, 1937	T,G,50	I	Steel casing.
282	--	70	f/	C,W	D,S	Steel casing. Reported irrigates small garden in summer.
283	1.5	76.1	Apr. 13, 1937	T,G,50	I	
284	--	--	--	T,--	I	Steel casing. Water reported in sand at 133 feet. See log.
285	1.2	78	Apr. 14, 1937	T,G,50	I	Steel casing. Reported irrigated 110 acres in 1936.
286	0.8	75.8	do.	T,G,50	I	Concrete curb; steel casing.
287	0.5	80.1	do.	C,W	D,S	Wood curb; steel casing. Reported irrigates small garden.
		80	Oct. 5, 1937			
288	0.5	73.4	Apr. 14, 1937	C,W	D,S	Do.
289	2	16.2	Apr. 13, 1937	C,W	I	Weak supply reported from caliche pebbles and sand.

Records of wells and springs in Lamb County--Continued

No.	Distance from Littlefield	Section or Labor	Survey, Block or League	Owner	Driller	Topographic situation	Date completed	Depth of well (ft.)	Diameter of well (in.)
290	13½ miles east	Sec. 56, SW¼NE¼	blk. 1, R.M.T. sur.	T. B. Elder	Henry P. Price	Ridge-top	1937	144	--
291	do.	Sec. 54, NW¼NW¼	do.	L. C. O'Neil	-- Sawyer	Gentle slope	1937	150	15
292	14 miles east	Sec. 55, NE¼NW¼	do.	W. B. Mann	A. B. Hayes	Rolling	1936	103	16
293	16 miles northeast	Sec. 16, SW¼SE¼	blk. B, T.A.T. sur.	Elwood Estate	--	Sand dunes	1931	84	4½
e/294	13½ miles east	Sec. 50, NW¼SE¼	blk. 1, R.M.T. sur.	G. R. Nabers	-- Whitfield	Gentle slope	1937	--	--
295	14 miles east	Sec. 34, SW¼SW¼	do.	J. P. Ratliff	--	Rolling	1937	167	--
e/296	13½ miles southeast	Sec. 120, NE¼SE¼	blk. A, R.M.T. sur.	Robert Roach	--	do.	--	130	--
297	12 miles southeast	Sec. 30, SE¼NE¼	blk. 1, R.M.T. sur.	S. N. Twilley	H. F. Bishop	do.	1937	139	15
298	12½ miles east	Sec. 36, SE¼NE¼	do.	W. T. Hopkins	do.	do.	1937	--	--
299	12 miles east	Sec. 36, NE¼NW¼	do.	W. O. Stacy	H. C. Forgason	do.	1937	155	15
e/300	9 miles east	Sec. 24, NW¼NW¼	do.	N. S. Young	A. B. Hayes	do.	1936	185	16
301	10 miles east	Sec. 21, NW¼SW¼	do.	A. W. Stanford	Whiten & Byers	Gentle slope	1937	163	15½
e/302	10 miles southeast	Sec. 17, SE¼SE¼	do.	O. L. McPherson	H. F. Bishop	do.	1937	131	15
303	10½ miles southeast	Sec. 123, NE¼NE¼	blk. A, R.M.T. sur.	J. C. Harper	-- Whitfield	do.	1937	125	15
304	do.	Sec. 123, NE¼NW¼	do.	J. E. Hamilton	-- Jones	do.	1937	120	15
e/305	10 miles southeast	Sec. 124, NE¼NE¼	do.	Mrs. Alice Lindsey Smith	-- Bishop	do.	1936	87	15
e/306	9½ miles southeast	Sec. 124, NW¼NW¼	do.	Donald Love	Fred Foust	Flat	--	100	17
e/307	do.	Sec. 125, NE¼SE¼	do.	J. T. Couch	do.	Gentle slope	1937	100	15
e/309	8½ miles east	Sec. 9, NW¼SE¼	blk. 1, R.M.T. sur.	M. V. Keasy	-- Bishop	do.	--	140	18
e/310	8 miles east	Sec. 10, SE¼SW¼	blk. T, T.A.T. sur.	Elwood Estate	Graham Oil & Gas Co.	--	1930	4,508	6-5/8
e/312	8½ miles southeast	Sec. 6, NW¼SE¼	blk. 1, R.M.T. sur.	R. H. Love	Fred Foust	Gentle slope	1937	80	17
e/313	7 miles southeast	Lab. 10, NW¼	Lge. 687	J. D. Lee	-- Rafe	do.	1937	100	15
314	6½ miles east	Lab. 20, NE¼	Lge. 671	A. F. Wedel	Bob Ferguson	Flat	1937	158	15
315	4¾ miles east	Lab. 7, NE¼	do.	C. W. Smiley	Fred Foust	Gentle slope	1936	155	15
e/320	7½ miles southeast	Lab. 24, SW¼	Lge. 687	M.R. & B.A. Fowler	L. J. Sheridan	do.	1937	143	15
e/321	4¾ miles southeast	Lab. 1, W½	Lge. 686	Brownlee & Goldsmith	--	do.	1916	99	6
322	4¼ miles southeast	Lab. 16, NW¼	Lge. 671	Yellowhouse Land Co.	--	Flat	--	--	--

W. L. Broadhurst, Project Superintendent

No.	Height of measuring point above ground (ft.) _{a/b/}	Water Level		Pump and power <u>c/</u>	Use of water <u>d/</u>	Remarks
		Depth below measuring point (ft.)	Date of measurement			
290	1.4	83.8	Apr. 13, 1937	T,G,50	I	Reported 16 feet drawdown after pumping 750 gallons a minute for 15 minutes.
291	1.5	87.8	Apr. 9, 1937	T,G,50	I	Reported 16 feet drawdown after pumping 800 gallons a minute for 8 hours.
292	--	--	--	T,G,50	I	Steel casing. Water reported in sand at 76 to 106 feet. Reported irrigated 120
293	1	68.4	Apr. 8, 1937	C,W	D,S	Wood curb; steel casing. acres in 1936. Reported irrigates small garden.
294	1.5	92.6	Apr. 9, 1937	T,G,50	I	
295	--	--	--	T,G,85	I	
296	1.5	96.9	May 6, 1937	T,--	I	
297	--	--	--	T,G,85	I	Reported strong supply.
298	--	--	--	T,G,85	I	Do.
299	1.6	78.6	Oct. 5, 1937	T,G,85	I	Do.
300	1	114	Apr. 9, 1937	T,G,85	I	Steel casing. Reported irrigated 130 acres in 1936.
301	--	--	--	T,G,85	I	Steel casing.
302	--	--	--	T,--	I	Do.
303	2	59.8	May 5, 1937	T,G,50	I	Steel casing. Reported 15.7 feet drawdown after pumping 1,150 gallons a minute for 1
304	1.5	51.3	May 7, 1937	T,G,50	I	Steel casing. Reported 6 feet drawdown after pumping about 600 gallons a
305	1.5	36.1	May 5, 1937	T,G,85	I	Steel casing. Nearest pumping well, 3/8 mile southeast. See
306	1.5	37.1	May 7, 1937	T,G,85	I	log.
307	2	34.2	May 5, 1937	T,--	I	Water reported in sands at 38, 58, and 85 feet.
309	1.5	60.2	May 7, 1937	T,G,--	I	Steel casing. Nearest pumping well, 1 1/2 miles east.
310	--	--	--	--	--	Oil test. See log.
312	1.2	42.7	May 7, 1937	T,G,85	I	Steel casing.
313	0.5	37.1	Apr. 29, 1937	T,--	I	Concrete curb; galvanized casing.
314	1	64.1	do.	T,--	I	Do.
315	--	--	--	T,G,85	I	Steel casing. Reported strong supply.
320	1	62.3	Apr. 29, 1937	--	--	Steel casing. See log.
321	2	80	do.	C,W	D,S	Galvanized casing.
322	1	41.9	do.	C,W	I	Concrete curb.

Records of wells and springs in Lamb County--Continued

No.	Distance from Littlefield	Section or Labor	Survey, Block or League	Owner	Driller	Topographic situation	Date completed	Depth of well (ft.)	Diameter of well (in.)
e/323	3 $\frac{1}{4}$ miles east	Lab. 25, NW $\frac{1}{4}$	Lge. 665	Rex Matthews	Fred Foust	Gentle slope	1936	124	64
e/324	3 miles east	Lab. 16, NW $\frac{1}{4}$	do.	W. H. Roberts	A. B. Hayes	do.	1936	140	15
e/325	1 $\frac{1}{2}$ miles east	Lab. 17, SE $\frac{1}{4}$	do.	R. L. Holden	H. C. Forgason	Rolling	1937	195	15
328	6 $\frac{1}{2}$ miles south	Lab. 23, SW $\frac{1}{4}$	Lge. 686	J. W. James	--	Edge of lake	1923	107	4
e/330	2 $\frac{1}{4}$ miles southwest	Lab. 5, SW $\frac{1}{4}$	Lge. 673	-- Markham	--	Gentle slope	1936	150	--
e/331	4 $\frac{1}{4}$ miles southwest	Lab. 1, SE $\frac{1}{4}$	Lge. 684	--	--	do.	--	100	4
332	4 $\frac{1}{2}$ miles southwest	Lab. 15, SE $\frac{1}{4}$	Lge. 674	Mrs. H. A. Gilliam	--	do.	--	102	4
e/333	3 $\frac{1}{4}$ miles west	Lab. 24, NW $\frac{1}{4}$	Lge. 663	Weeks-Bagwell Gin Co.	--	do.	--	179	--
e/334	do.	do.	do.	do.	--	do.	--	202	--
e/335	10 miles west	Lab. 1, SE $\frac{1}{4}$	Lge. 677	W. C. Holeman	Fred Foust	Flat	1932	155	5-3/16
336	10 $\frac{1}{2}$ miles west	Lab. 2, NW $\frac{1}{4}$	do.	do.	--	do.	1925	75	6
e/337	11 miles southwest	Lab. 3, SW $\frac{1}{4}$	Lge. 697	Yellowhouse Land Co.	--	--	1927	4,240	6-5/8
e/338	13 miles west	Lab. 10, SW $\frac{1}{4}$	Lge. 678	J. R. Reed	J. M. White	Rolling	1937	94	--
339	15 $\frac{1}{2}$ miles west	Lab. 1, NE $\frac{1}{4}$	Lge. 679	S. A. Williams	--	Flat	1929	103	--
340	16 miles west	Lab. 25, SW $\frac{1}{4}$	Lge. 680	Frances Albus	--	do.	1935	79	--
341	1 $\frac{1}{2}$ miles east	Lab. 14, SW $\frac{1}{4}$	Lge. 665	City of Littlefield	Fred Foust	Gentle slope	1935	136	15 $\frac{1}{2}$
342	do.	do.	do.	do.	A. B. Hayes	--	1936	130	12 $\frac{1}{2}$

- a/ Measuring point was usually top of casing, top of pump base, or top of well curb.
 b/ Measuring point above ground unless below ground indicated by minus (-) sign.
 c/ C, cylinder; T, turbine; Cf, centrifugal; W, windmill; G, gasoline engine; E, electroc motor; Tr, tractor; D, diesel; H, hand; B, bucket or bailer; number indicates horsepower.

W. L. Broadhurst, Project Superintendent

No.	Height of measuring point above ground (ft.) ^{a/b/}	Water Level		Pump and power	Use of water	Remarks
		Depth below measuring point (ft.)	Date of measurement			
323	0.5	50.2	May 1, 1937	T,G,85	I	Steel casing. Dug well, 0 to 50 feet; drilled well to bottom.
324	--	--	--	T,G,85	I	Steel casing.
325	--	--	--	T,--	I	Steel casing. See log.
328	1	82.4	Apr. 29, 1937	C,W	D,S	Steel casing. Reported weak supply.
330	0.7	84.9	Mar. 22, 1937	C,H	D,S	Wood curb. Water reported in red sand.
331	0.8	78.1	do.	C,W	D,S	Wood curb; galvanized casing.
332	1	73.2	do.	C,W	D,S	Do.
333	0	158.3	do.	--	Ind	No casing.
334	1	159.5	do.	--	Ind	Do.
335	0.4	113.5	Mar. 9, 1937	C,W	D,S	Reported weak supply.
336	0.8	62.5	Mar. 11, 1937	C,W	D,S	Wood curb; tin casing. Reported strong supply.
337	--	--	--	--	--	Oil test. See log.
338	0	70.8	Mar. 12, 1937	None	N	Weak supply reported in sand and gravel at 80 to 85 feet. See log.
339	0.8	78.2	do.	C,W	D,S	Wood curb. Reported irrigates small garden.
340	0.4	68.1	do.	C,W	D,S	Wood curb. Reported weak supply.
341	0	66	Oct. 7, 1937	T,E,30	P	Steel casing. Strong supply reported in white sand at 119 to 136 feet. See log.
342	0	59	do.	T,E,25	P	Steel casing. Water reported in white sand at 112 to 129 feet. Reported 38 feet drawdown after pumping 400 gallons a minute for 16 hours. See log.

^{d/} D, domestic; S, stock; I, irrigation; P, public; N, not used.

^{e/} No water sample collected for analysis.

^{f/} Water level reported.

Table of Drillers' Logs, Lamb County, Texas

	Thickness (feet)	Depth (feet)
<u>Driller's log of well 16</u>		
R. L. Brown property, 11 $\frac{1}{2}$ miles west of Earth.		
Soil- - - - -	3	3
White and brown clay- - - -	26	29
Hard water sand- - - - -	11	40
Brown clay- - - - -	20	60
Soft red water sand - - - -	11	71
Gray clay- - - - -	16	87
White water sand- - - - -	7	94
Brown water sand- - - - -	6	100
TOTAL DEPTH- - - - -		100

	Thickness (feet)	Depth (feet)
<u>Driller's log of well 51</u>		
R. F. Jackson's property, 2 $\frac{1}{2}$ miles north-east of Earth.		
Soil- - - - -	3	3
Red rock- - - - -	8	11
Gray rock- - - - -	29	40
White, limy sand rock- - -	3	43
Gray sand rock- - - - -	17	60
White magnesia- - - - -	18	78
Gray lime- - - - -	4	82
Gray water sand- - - - -	11	93
TOTAL DEPTH- - - - -		93

	Thickness (feet)	Depth (feet)
<u>Driller's log of well 284</u>		
Susan D. Huff property, 14 miles north-east of Littlefield.		
Soil- - - - -	3	3
Caliche- - - - -	22	25
White rock- - - - -	1	26
Caliche- - - - -	19	45
Joint clay- - - - -	15	60
Lime boulders- - - - -	5	65
Water sand- - - - -	3	68
Packed sand- - - - -	34	102
Water sand- - - - -	8	110
Packed sand- - - - -	23	133
Water sand- - - - -	17	150
TOTAL DEPTH- - - - -		150

	Thickness (feet)	Depth (feet)
<u>Driller's log of well 305</u>		
Mrs. Alice Lindsey Smith tract, 10 miles southeast of Littlefield.		
No record- - - - -	27	27
Water sand- - - - -	4	31
Yellow clay- - - - -	17	48
Water sand- - - - -	8	56
Clay- - - - -	24	80
Water sand- - - - -	10	90
Clay- - - - -	1	91
TOTAL DEPTH- - - - -		91

	Thickness (feet)	Depth (feet)
<u>Driller's log of well 310</u>		
Graham Oil and Gas Co., Ellwood Estate lease well number 1. 8 miles east of Littlefield.		
Red sand- - - - -	10	10
White clay- - - - -	10	20
Red clay and red rock - - -	65	85
Quicksand- - - - -	227	312
Red rock- - - - -	8	320
Gray shale- - - - -	8	328
Red rock- - - - -	12	340
Blue shale- - - - -	10	350
Red rock- - - - -	35	385
Blue shale- - - - -	27	412
Water sand, hole full of water- - - - -	35	447
Blue shale- - - - -	53	500
Gray sandy shale- - - - -	12	512
Red rock- - - - -	38	550
Red and blue shale- - - - -	40	590
Blue shale- - - - -	40	630
Gray sand, hole full of water- - - - -	35	665
Red rock- - - - -	20	685
Gray shale- - - - -	15	700
Blue shale- - - - -	90	790
Hard gray lime- - - - -	10	800
Broken gray lime- - - - -	25	825
Blue shale- - - - -	75	900
Hard gray lime- - - - -	10	910
Blue shale- - - - -	65	975
Red shale- - - - -	30	1005
Soft red shale- - - - -	60	1065
Gray shale- - - - -	20	1085
Soft red shale- - - - -	20	1105
Gray shale- - - - -	10	1115
Red shale- - - - -	65	1180
Red bed- - - - -	20	1200
Red shale- - - - -	50	1250
Blue shale- - - - -	15	1265
Water sand, (400 feet of water)- - - - -	15	1270
Sandy blue shale- - - - -	15	1295
White water sand, hole full of water- - - - -	20	1315
White shale- - - - -	50	1365
Red rock- - - - -	10	1375
White water sand, hole full of water- - - - -	53	1428
Red rock- - - - -	32	1460
Blue shale- - - - -	5	1465
Red rock- - - - -	80	1545
Anhydrite and lime- - - - -	35	1580
Red rock- - - - -	25	1605
Gray lime- - - - -	10	1515

(Continued on next page)

Table of Drillers' Logs, Lamb County--Continued

	Thickness (feet)	Depth (feet)
<u>Driller's log of well 310--Continued</u>		
Red rock- - - - -	36	1651
Light salt- - - - -	10	1661
TOTAL DEPTH- - - - -		4508

<u>Driller's log of well 320</u>		
M. R. and B. A. Fowler property, 7½ miles southeast of Littlefield.		
Soil- - - - -	4	4
Caliche and clay- - - - -	36	40
Rocky soil- - - - -	15	55
Clay- - - - -	8	63
Water sand and clay - - - -	4	67
Yellow clay - - - - -	9	76
Red and yellow water sand -	5	81
Yellow clay - - - - -	42	123
White water sand- - - - -	17	140
Blue clay- - - - -	3	143
TOTAL DEPTH- - - - -		143

<u>Driller's log of well 325</u>		
R. L. Holden property, 1½ miles east of Littlefield.		
Soil- - - - -	7	7
Caliche - - - - -	24	31
Hard sandy lime rock- - - -	5	36
Dry sand- - - - -	34	70
Water sand- - - - -	4	74
Red caliche - - - - -	12	86
Dry white sand- - - - -	11	97
Water gravel- - - - -	4	101
Yellow clay - - - - -	30	131
Blue clay or shale- - - - -	49	180
Water sand- - - - -	15	195
TOTAL DEPTH- - - - -		195

<u>Driller's log of well 337</u>		
Leigh Taliferro Co., Yellowhouse Land Co. Well number 1, 11 miles southwest of Littlefield.		
Surface soil- - - - -	4	4
Clay and gypsum - - - - -	15	19
Water sand- - - - -	5	24
Clay and shale- - - - -	6	30
Water sand- - - - -	4	34
Blue shale- - - - -	2	36
Brown sandy lime- - - - -	1	37
Sandy lime- - - - -	4	41
Water sand and gravel - - - -	9	50
Sandy clay- - - - -	40	90
Red beds- - - - -	25	115
Red gumbo - - - - -	15	130
Red beds and traces of lime-	105	235
Red beds and lime - - - - -	75	310
Red beds, streaks of lime and blue gumbo- - - - -	17	327

	Thickness (feet)	Depth (feet)
<u>Driller's log of well 337--Continued</u>		
Lime- - - - -	3	330
Broken shale and lime - -	16	346
Red beds, lime and boulders- - - - -	29	375
Hard lime - - - - -	10	385
Sticky red gumbo- - - - -	25	410
Red gumbo and gypsum- - -	12	422
Broken sand lime and shale-	33	455
Broken sandy lime and red shale- - - - -	54	509
Hard sandy lime, water- -	11	520
Broken lime, salt water -	18	538
TOTAL DEPTH- - - - -		4240

<u>Driller's log of well 338</u>		
J. R. Reed property, 13 miles west of Littlefield.		
Soil- - - - -	3	3
Rock- - - - -	9	12
Medium hard caliche- - - -	18	30
Birds eye clay - - - - -	50	80
Water sand and gravel- - -	5	85
Hard and soft sand and gravel- - - - -	8	93
Yellow clay - - - - -	19	112
Blue shale- - - - -	60	172
Hard rock- - - - -	4	176
Soft rock (little water) -	1	177
Blue sandy shale - - - - -	8	185
Hard rock- - - - -	10	195
Water formation- - - - -	1	196
Rocky blue shale - - - - -	4	200
TOTAL DEPTH- - - - -		200

<u>Driller's log of well 341</u>		
Leslie B. Davis farm, labor 14, league 665, 1½ miles east of Littlefield.		
Sub-soil- - - - -	3	3
Chalk- - - - -	3	6
Pink clay- - - - -	14	20
Sandy pink clay- - - - -	6	26
Rock- - - - -	5	31
Caliche- - - - -	9	40
Pink sand and caliche- - -	20	60
Pink sand, seeps - - - - -	9	69
Water sand and gravel- - -	13	82
Water sand and gravel with clay balls- - - - -	5	87
White water sand - - - - -	11	98
Water gravel- - - - -	2	100
Yellow clay - - - - -	19	119
Water sand- - - - -	5	124
Water sand and gravel- - -	12	136

(Continued on next page)

Table of Drillers' Logs, Lamb County--Continued

	Thickness (feet)	Depth (feet)
<u>Driller's log of well 341--Continued</u>		
Yellow clay- - - - -	12	148
TOTAL DEPTH- - - - -		148

Driller's log of well 342
 Leslie B. Davis farm, labor 14, league
 665, 1 $\frac{1}{2}$ miles east of Littlefield.

Sub-soil- - - - -	4	4
Chalk- - - - -	5	9
Pink clay- - - - -	13	22
Sandy pink clay- - - - -	5	27

	Thickness (feet)	Depth (feet)
<u>Driller's log of well 342--Continued</u>		
Rock chalk- - - - -	3	30
Caliche- - - - -	8	38
Pink sand and caliche- - -	19	57
Pink sand, seeps - - - - -	11	68
Water sand and gravel- - -	12	80
Pink clay- - - - -	14	94
White water sand - - - - -	4	98
Yellow clay- - - - -	17	115
Water sand and gravel- - -	13	128
Yellow clay- - - - -	2	130
TOTAL DEPTH- - - - -		130

Logs of wells drilled by W. P. A. labor in Lamb County, Texas
 Samples examined and classified by W. L. Broadhurst, Project Superintendent.

	Thickness (feet)	Depth (feet)
<u>Well 5</u>		
Flat, north side county road, southeast corner, NW $\frac{1}{4}$ sec. 35, blk. W. 11 $\frac{1}{2}$ miles west of Earth.		
Dark surface soil - - - - -	2	2
Light powdery clay - - - - -	4	6
Caliche - - - - -	10	16
Sandy red clay - - - - -	1	17
Caliche and red sandy clay -	10	27
Water level, 22.2 feet below top of ground, $\frac{1}{4}$ hour after hole completed.		
Water sample collected. Jan. 28, 1937.		

<u>Well 9</u>		
Flat, State Highway 70, NW $\frac{1}{4}$ SW $\frac{1}{4}$ sec. 52, blk. W. 10 $\frac{1}{2}$ miles west of Earth.		
Dark sandy soil - - - - -	2	2
Caliche - - - - -	22	24
Water level, 11.3 feet below top of ground, 24 hours after hole completed.		
Water sample collected. Jan. 19, 1937.		

<u>Well 11</u>		
Flat, State Highway No. 70, NW $\frac{1}{4}$ SW $\frac{1}{4}$ sec. 53, blk. W. 9 $\frac{1}{2}$ miles west of Earth.		
Dark sandy soil - - - - -	1	1
Caliche - - - - -	21	22
Water level, 9.5 feet below top of ground, 24 hours after hole completed.		
Water sample collected. Jan. 19, 1937.		

<u>Well 18</u>		
Flat, along county road, south side SE $\frac{1}{4}$ NW $\frac{1}{4}$ sec. 36, blk. W. 10 $\frac{1}{2}$ miles west of Earth.		
Dark soil - - - - -	1	1
Light fine-grained sandy soil	3	4
Caliche and red clay - - -	8	12
Caliche and yellow clay - -	4	16
Fine-grained sandy clay - -	2	18
White caliche - - - - -	1	19
Fine-grained sandy caliche and clay - - - - -	6	25
Fine-grained sandy clay - -	22	47
Water level, 20.6 feet below top of ground, 16 hours after hole completed.		
Water sample collected. Feb. 4, 1937.		

<u>Well 20</u>		
Flat, J. Roubineck tract, east side NE $\frac{1}{2}$ SE $\frac{1}{4}$ sec. 36, blk. W. 10 miles west of Earth.		
Dark soil - - - - -	1	1
Light-colored sandy clay - -	4	5
Caliche - - - - -	10	15

	Thickness (feet)	Depth (feet)
<u>Log of well 20--Continued</u>		
Caliche and fine-grained clay	2	17
Caliche - - - - -	8	25
Water level, 19 feet below top of ground, $\frac{1}{4}$ hour after hole completed.		
Water sample collected. Feb. 4, 1937.		

<u>Well 22</u>		
Flat, 100 yards north of road, SW $\frac{1}{2}$ NW $\frac{1}{4}$ sec. 44, blk. W. 9 $\frac{1}{2}$ miles west of Earth.		
Light-colored soil - - - - -	1	1
Light-colored powdery clay -	3	4
Clay and caliche - - - - -	7	11
Red sandy clay - - - - -	2	13
Caliche - - - - -	1	14
Fine-grained sand - - - - -	3	17
Fine-grained sand, clay and gravel - - - - -	1	18
Rock - - - - -		18
No water sample collected. Jan. 26, 1937.		

<u>Well 23</u>		
Flat, in barrow ditch 2 feet deep along county road, SW $\frac{1}{2}$ NW $\frac{1}{4}$ sec. 44, blk. W. 9 $\frac{1}{2}$ miles west of Earth.		
Soft caliche - - - - -	3	3
Hard caliche - - - - -	3	6
No water sample collected. Jan. 26, 1937.		

<u>Well 25</u>		
Flat, along State Highway No. 70, NE $\frac{1}{2}$ SE $\frac{1}{4}$ sec. 53, blk. W. 9 miles west of Earth.		
Topsoil - - - - -	2	2
Caliche - - - - -	8	10
Caliche and red sand - - - -	1	11
Caliche - - - - -	22	33
Water level, 8.4 feet below top of ground, 1 hour after hole completed.		
Water sample collected. Jan. 25, 1937.		

<u>Well 27</u>		
South side of State Highway No. 70, 3.8 miles east of Bailey Land Co. line, opposite center of caliche pit, 4 feet from fence, NE $\frac{1}{2}$ SE $\frac{1}{4}$ sec. 54, blk. W. 8 miles west of Earth.		
Light soil - - - - -	1	1
Caliche - - - - -	28	29
Water level, 8.5 feet below top of ground, 1 hour after hole completed.		
Water sample collected. Jan. 25, 1937.		

Logs of W. P. A. test wells in Lamb County--Continued

	Thickness (feet)	Depth (feet)
<u>Well 32</u>		
Northeast corner of Soda Lake, on Halsell Cattle Co. land, northwest corner sec. 8, blk. S-2, 6 $\frac{1}{2}$ miles west of Earth.		
Blue clay and soil - - - - -	6	6
Sand, gravel and caliche - - -	2	8
Caliche - - - - -	4	12
Caliche and fine-grained sand	5	17
Caliche - - - - -	7	24
Light-colored mucky alkaline caliche - - - - -	5	29
Blue mucky alkaline caliche -	5	34
Water level, 15 feet below top of ground, $\frac{1}{4}$ hour after hole completed.		
Water sample collected. Feb. 10, 1937.		

<u>Well 34</u>		
Flat, along county road close to Blackwater Draw, NE $\frac{1}{2}$ SE $\frac{1}{4}$ sec. 56, blk. W. 6 $\frac{1}{2}$ miles west of Earth.		
Blue clay and soil - - - - -	1	1
Caliche and limy boulders - -	5	6
No water sample collected. Feb. 5, 1937.		

<u>Well 35</u>		
Flat, along county road, SE $\frac{1}{4}$ N $\frac{1}{2}$ sec. 41, blk. W. 6 $\frac{1}{2}$ miles west of Earth.		
Dark soil - - - - -	1	1
Blue clay and soil - - - - -	1	2
Soft caliche - - - - -	3	5
Hard caliche - - - - -	7	12
No water sample collected. Feb. 5, 1937.		

<u>Well 39</u>		
Slope, edge of Spring Lake, 150 yards west of culvert, north side NE $\frac{1}{4}$ sec. 73, blk. 2, Halsell Subdivision, 5 $\frac{1}{2}$ miles west of Earth.		
Dark loam - - - - -	2	2
Sandy white clay and caliche gravel - - - - -	13	15
Water level, 6.5 feet below top of ground, $\frac{1}{4}$ hour after hole completed.		
Water sample collected. Mar. 16, 1937.		

<u>Well 74</u>		
Gentle slope, northwest corner sec. 8, blk. 05, 12 $\frac{1}{2}$ miles east of Earth.		
Topsoil - - - - -	2	2
Red sand and caliche - - - -	3	5
Caliche - - - - -	1	6
Red sand and caliche - - - -	5	11
No water sample collected. May 31, 1937.		

	Thickness (feet)	Depth (feet)
<u>Well 75</u>		
Rolling, edge of sand hills, southwest corner sec. 8, blk. 05, 13 miles southeast of Earth.		
Sand - - - - -	8	8
Sand and caliche - - - - -	9	17
No water sample collected. June 3, 1937.		

<u>Well 80</u>		
Rolling sand hills, along county road, 100 feet north of gate, 20 feet east of fence, NE $\frac{1}{2}$ NE $\frac{1}{4}$ sec. 29, blk. T 1, T. A. Thompson survey, 8 miles southeast of Earth.		
Buff-colored sand with		
little clay - - - - -	7	7
Caliche - - - - -	4	11
Sandy clay and caliche - - -	19	30
No water sample collected. Mar. 31, 1937.		

<u>Well 82</u>		
Rolling sand hills, on east side borrow pit, 100 feet south of turn in county road, center sec. 39, blk. T 1, T. A. Thompson survey, 10 $\frac{1}{2}$ miles southeast of Earth.		
Yellow clay - - - - -	6	6
Sandy yellow clay and caliche	6	12
Hard rock and clay - - - - -	11	23
Calcareous sandy clay - - - -	8	31
No water sample collected. Mar. 26, 1937.		

<u>Well 95</u>		
Bed of shallow dry lake, along county road, northeast corner labor 22, league 222, 10 $\frac{1}{2}$ miles southwest of Earth.		
Dark loam - - - - -	2	2
Soil and caliche - - - - -	4	6
Light-colored calcareous sandy clay - - - - -	8	14
Reddish-gray limy and sandy clay - - - - -	7	21
Fine-grained red sand with little clay - - - - -	3	24
Dark loam - - - - -	1	25
Reddish-yellow clay - - - -	3	28
Light-colored sand and caliche - - - - -	2	30
Caliche and gypsum - - - - -	3	33
Light-colored clay, gypsum, little sand - - - - -	8	41
Water level, 32.3 feet below top of ground, $\frac{1}{4}$ hour after hole completed.		
Water sample collected. Feb. 24, 1937.		

Logs of W. P. A. test wells in Lamb County--Continued

	Thickness (feet)	Depth (feet)
<u>Well 97</u>		
Rolling sand hills, along county road, northeast corner labor 2, league 222, 9 miles southwest of Earth.		
Light brown sandy soil- - -	3	3
Sandy red clay- - - - -	2	5
Red clay and caliche- - -	3	8
Yellow powdery clay- - - -	5	13
Fine-grained yellow sand - -	4	17
Light-colored clay and caliche- - - - -	4	21
Sandy yellow clay and lime -	3	24
Sandy yellow clay and caliche	5	29
Red sand rock- - - - -	1	30
No water sample collected. Feb. 23, 1937.		

	Thickness (feet)	Depth (feet)
<u>Well 99</u>		
Barrow pit at edge of sand ridge, west side county road, 8 feet from fence, NE $\frac{1}{4}$ NW $\frac{1}{4}$ labor 17, league 236, 7 miles southwest of Earth.		
Sandy brown and yellow clay-	5	5
Gumbo and sand- - - - -	4	9
Caliche and sand- - - - -	11	20
Fine-grained yellow sandy clay- - - - -	9	29
Rock- - - - -		29
Water level, 19.3 feet below top of ground, $\frac{1}{4}$ hour after hole completed.		
Water sample collected. Feb. 10, 1937.		

	Thickness (feet)	Depth (feet)
<u>Well 100</u>		
Barrow pit, west side of county road, labor 236, 7 miles southwest of Earth.		
Dark-colored sand- - - - -	1	1
Light-colored sand- - - - -	4	5
Sandy soil- - - - -	1	6
Light-colored sandy clay and caliche- - - - -	8	14
Hard rock and caliche- - -		14
No water sample collected. Feb. 8, 1937.		

	Thickness (feet)	Depth (feet)
<u>Well 104</u>		
Railroad cut, south side of railroad, NW $\frac{1}{4}$ labor 17, league 218, 13 miles southwest of Earth.		
Dark-colored clay and soil-	3	3
Light-colored sandy clay and caliche- - - - -	5	8
Fine-grained red sand- - -	3	11
Light-colored sandy clay with yellow streaks- - - - -	9	20
Sandy red clay with streaks of lime- - - - -	6	26
Fine brick-red sand with streaks of lime- - - - -	13	39
Sandy red clay- - - - -	4	43
Rock- - - - -		43
No water sample collected. Feb. 22, 1937.		

	Thickness (feet)	Depth (feet)
<u>Well 106</u>		
Bottom of railroad cut, south side of railroad, center labor 2, league 207, 13 $\frac{1}{2}$ miles southwest of Earth.		
Light-colored sandy clay- -	2	2
Reddish-yellow sandy clay- -	19	21
Fine-grained red sand- - -	3	24
Light-red sandy clay - - - -	7	31
Light-colored limy clay- - -	8	39
Light-colored sandy clay - -	3	42
Fine-grained red sand- - - -	6	48
Water level, 33.8 feet below top of ground, 125 days after hole completed.		
Water sample collected. Feb. 19, 1937.		

	Thickness (feet)	Depth (feet)
<u>Well 202</u>		
South edge small dry lake, along county road, SE $\frac{1}{4}$ labor 21, league 208, 18 $\frac{1}{2}$ miles northwest of Littlefield.		
Sandy soil- - - - -	2	2
Sandy clay and caliche- - -	5	7
Fine-grained white sand - - -	1	8
Sticky sand- - - - -	4	12
Yellow clay and caliche- - -	1	13
Greenish-colored clay- - - -	7	20
Green and yellow clay and sand- - - - -	17	37
No water sample collected. Feb. 27, 1937.		

	Thickness (feet)	Depth (feet)
<u>Well 203</u>		
Barrow ditch along county road at edge small dry lake, northeast corner labor 6, league 215, 16.5 miles northwest of Littlefield.		
Clay loam- - - - -	1	1
Bluish-gray clay- - - - -	10	11
Green and yellow sandy clay -	4	15
Fine-grained white sand- - -	2	17
Greenish-yellow clay- - - -	1	18
Green and gray clay- - - - -	4	22
Brown and yellow clay with black sand nodules- - - - -	1	23
Light-greenish clay- - - - -	4	27
Yellow-green clay- - - - -	3	30
Yellow and green sandy clay -	3	33
No water sample collected. Feb. 27, 1937.		

	Thickness (feet)	Depth (feet)
<u>Well 213</u>		
Barrow pit along south side railroad and west N-S road, southeast corner labor 10, league 217, 17 miles northwest of Littlefield.		
Sandy brownish-yellow clay- -	2	2
Brownish-yellow clay and caliche- - - - -	8	10
Sticky buff-colored clay and caliche- - - - -	4	14
(Continued on next page)		

Logs of W. P. A. test wells in Lamb County--Continued

	Thickness (feet)	Depth (feet)
<u>Well 213--Continued</u>		
Chocolate-colored clay and caliche- - - - -	6	20
Rock- - - - -		20
No water sample collected. Feb. 25, 1937.		

	Thickness (feet)	Depth (feet)
<u>Well 214</u>		
Barrow pit along east central section, league 223, 16 miles northwest of Littlefield.		
Chocolate-colored soil and clay- - - - -	4	4
Clay and caliche- - - - -	4	8
Sandy yellow clay and caliche	6	14
Sticky fine-grained yellow sand- - - - -	5	19
No water sample collected. Feb. 25, 1937.		

	Thickness (feet)	Depth (feet)
<u>Well 218</u>		
Lake bed, north side NE $\frac{1}{4}$ labor 25, league 231, 12 $\frac{1}{2}$ miles northwest of Littlefield.		
Light-blue clay- - - - -	5	5
Gray clay- - - - -	14	19
Fine-grained light-colored sandy clay - - - - -	16	35
No water sample collected. Mar. 11, 1937.		

	Thickness (feet)	Depth (feet)
<u>Well 219</u>		
Slope on west side dry lake, NW $\frac{1}{4}$ NW $\frac{1}{4}$ labor 25, league 231, 12 $\frac{1}{2}$ miles northwest of Littlefield.		
Sandy red soil- - - - -	4	4
Light-blue powdery clay and small caliche gravel- - -	2	6
White sand- - - - -	1	7
Light-green limy sand with streaks of yellow clay and sandy lime gravel- - -	26	33
No water sample collected. Mar. 11, 1937		

	Thickness (feet)	Depth (feet)
<u>Well 227</u>		
Depression in rolling sandy land, along county road, NE $\frac{1}{4}$ labor 2, league 231, 12 $\frac{1}{2}$ miles northwest of Littlefield.		
Sandy loam- - - - -	2	2
Sandy clayey subsoil- - -	1	3
Sandy clay and caliche- - -	12	15
Fine yellow sandy clay and lime- - - - -	14	29
Light-colored sandy clay and lime- - - - -	8	37
Brownish-yellow sandy clay and lime- - - - -	2	39
Rock- - - - -		39
No water sample collected. Mar. 8, 1937.		

	Thickness (feet)	Depth (feet)
<u>Well 229</u>		
Slope at edge small dry lake, along county road, SE $\frac{1}{4}$ SE $\frac{1}{4}$ labor 11, league 231, 11 miles northwest of Littlefield.		
Dark-colored sandy loam- - -	2	2
Caliche and clay- - - - -	2	4
White sand and caliche - - -	2	6
Yellow sand and lime- - - -	4	10
White sand and lime- - - - -	1	11
Caliche- - - - -	1	12
Yellow sand and lime - - - -	3	15
Fine-grained white sand- - -	1	16
White sand and caliche - - -	3	19
Caliche- - - - -	4	23
Calcareous clay- - - - -	5	28
Greenish-colored sandy clay-	5	33
Limy sandy clay and hard sand rock- - - - -	4	37
No water sample collected. Mar. 9, 1937.		

	Thickness (feet)	Depth (feet)
<u>Well 244</u>		
Flat, southwest corner NW $\frac{1}{4}$ labor 7, league 664, 1 $\frac{3}{4}$ miles northwest of Littlefield.		
Soil- - - - -	3	3
Clay and caliche- - - - -	4	7
Sandy red clay- - - - -	8	15
No water sample collected. Apr. 28, 1937.		

	Thickness (feet)	Depth (feet)
<u>Well 245</u>		
Flat, NW $\frac{1}{4}$ SW $\frac{1}{4}$ labor 7, league 664, 1 $\frac{3}{4}$ miles northwest of Littlefield.		
Soil- - - - -	4	4
Caliche- - - - -	3	7
Buff-colored clay- - - - -	5	12
Sandy red clay and rock- - -	7	19
No water sample collected. Apr. 21, 1937.		

	Thickness (feet)	Depth (feet)
<u>Well 246</u>		
Slope at edge of dry lake, along county road, northeast corner labor 17, league 664, $\frac{3}{4}$ mile west of Littlefield.		
Soil- - - - -	2	2
Caliche- - - - -	5	7
Clay and caliche- - - - -	6	13
Sandy red clay- - - - -	5	18
Red sand- - - - -	2	20
Sandy red caliche- - - - -	10	30
No water sample collected. Apr. 21, 1937.		

	Thickness (feet)	Depth (feet)
<u>Well 253</u>		
Shallow lake bed, 100 feet northeast from center line of crossroad, southwest corner labor 20, league 650 $\frac{1}{2}$ miles north of Littlefield.		

(Continued on next page)

Logs of W. P. A. test wells in Lamb County--Continued

	Thickness (feet)	Depth (feet)
<u>Log of well 253--Continued</u>		
Dark-colored clay soil- - - - -	7	7
Gray and yellow clay and sand	3	10
Sand- - - - -	17	27
Buff-colored clay- - - - -	7	34
Light-colored sandy clay - -	11	45
Sandy red clay- - - - -	18	63
Water level, 46.3 feet below top of ground, 96 hours after hole completed.		
Water sample collected. Apr. 1, 1937.		

<u>Well 254</u>		
Slope at edge small dry lake, along county road, 6 feet south fence corner, northwest corner labor 11, league 659, 3 $\frac{1}{2}$ miles north Littlefield.		
Dark-colored soil- - - - -	1	1
Red clay- - - - -	2	3
Buff-colored sand- - - - -	4	7
Sandy clay and caliche - - -	15	22
Light-colored limy sand- - -	10	32
Clay and sand with gypsum- -	5	37
Sand rock, clay and gravel- - - - -	1	38
Sand and sandy lime rock - -	12	50
No water sample collected. Mar. 18, 1937.		

<u>Well 255</u>		
Flat, southwest corner pasture fence NW $\frac{1}{4}$ SW $\frac{1}{4}$ labor 20, league 659, 2 $\frac{3}{4}$ miles north of Littlefield.		
Soil- - - - -	3	3
Sandy clay and caliche- - -	24	27
Yellow clay- - - - -	4	31
Hard sand rock- - - - -	1	32
No water sample collected. Mar. 18, 1937.		

<u>Well 259</u>		
Hillside at edge of draw, 20 feet south of bridge on "T" road, northeast corner labor 4, league 651, 7 $\frac{1}{2}$ miles north of Littlefield.		
Loam- - - - -	1	1
Sandy clay- - - - -	11	12
Dark loam- - - - -	2	14
Sand- - - - -	5	19
Water level, 14 feet below top of ground, 96 hours after hole completed.		
Water sample collected. Apr. 1, 1937.		

<u>Well 261</u>		
Hillside slope to creek, 100 yards north of bridge, SW $\frac{1}{4}$ SW $\frac{1}{4}$ labor 24, league 642, 8 $\frac{1}{2}$ miles northeast of Littlefield.		
Soil- - - - -	3	3
Yellow clay- - - - -	7	10

	Thickness (feet)	Depth (feet)
<u>Log of well 261--Continued</u>		
Sandy blue clay- - - - -	8	18
Water level, 11.2 feet below top of ground, 96 hours after hole completed.		
Water sample collected. Apr. 12, 1937.		

<u>Well 262</u>		
Creek bank, 50 feet south of bridge, east side NE $\frac{1}{4}$ labor 5, league 652, 8 miles northeast of Littlefield.		
Soil- - - - -	5	5
Blue clay- - - - -	3	8
Fine-grained white sand- - -	4	12
Water level, 4.4 feet below top of ground, 96 hours after hole completed.		
Water sample collected. Apr. 12, 1937.		

<u>Well 263</u>		
Hillside at slope to creek, along county road, east side NE $\frac{1}{4}$ labor 5, league 652, 8 miles northeast of Littlefield.		
Brownish-yellow clay soil- -	9	9
Bluish-gray clay and sand- -	6	15
Water level, 10.2 feet below top of ground, 96 hours after hole completed.		
Water sample collected. Apr. 12, 1937.		

<u>Well 264</u>		
Bed of lake, center labor 7, league 657, 6 miles northeast of Littlefield.		
Blue clay- - - - -	6	6
Green clay- - - - -	10	16
Gray clay- - - - -	24	40
Water level, 23.2 feet below top of ground, $\frac{1}{2}$ hour after hole completed.		
Water sample collected. Apr. 13, 1937.		

<u>Well 265</u>		
Slope at edge of lake, 50 feet northwest of county road crossing, southeast corner labor 6, league 657, 5 $\frac{1}{2}$ miles northeast of Littlefield.		
Soil- - - - -	1	1
White clay- - - - -	2	3
Yellow clay- - - - -	6	9
Caliche- - - - -	2	11
Sandy brown clay - - - - -	10	21
Hard limy sand rock and sandy yellow clay- - - - -		
	10	31
Dry sand- - - - -	4	35
Mixed caliche and sandy clay	10	45
Water level, 39 feet below top of ground, 1 hour after hole completed.		
Water sample collected. Apr. 14, 1937.		

Logs of W. P. A. test wells in Lamb County--Continued

	Thickness (feet)	Depth (feet)
--	---------------------	-----------------

Well 269

Creek bank along county road, northeast corner labor 3, league 652, 9 miles northeast of Littlefield.

Soil- - - - -	8	8
Blue clay- - - - -	3	11
Fine-grained white sand- - -	3	14
Water level, 7.6 feet below top of ground, 96 hours after hole completed.		
Water sample collected. Apr. 12, 1937.		

Well 270

Hillside, at slope to creek along county road, west side SW $\frac{1}{4}$ labor 22, league 642, 9 miles northeast of Littlefield.

Soil- - - - -	5	5
Yellow clay- - - - -	11	16
Limy clay- - - - -	5	21
No water sample collected. Apr. 8, 1937.		

Well 308

Flat, along county road, southwest corner SW $\frac{1}{4}$ sec. 7, blk. 1, R. M. Thompson survey, 9 miles east of Littlefield.

Loamy soil- - - - -	1	1
Caliche- - - - -	7	8
Pale green clay- - - - -	1	9
Buff. and green clay and lime	8	17
Caliche- - - - -	7	24
No water sample collected. May 6, 1937.		

Well 311

Slope near edge of lake, along county road, northeast corner sec. 5, blk. 1, R. M. Thompson survey, 8 miles southeast of Littlefield.

Loamy soil- - - - -	2	2
Clay and caliche- - - - -	22	24
No water sample collected. May 6, 1937.		

Well 316

Flat, along county road, southwest corner labor 19, league 666, 4 miles east of Littlefield.

Loam soil- - - - -	3	3
Clay and caliche- - - - -	7	10
Brown and buff-colored clay		
and lime- - - - -	12	22
No water sample collected. May 5, 1937.		

Well 317

Slope, near edge draw, southeast corner, NE $\frac{1}{4}$ labor 6, league 671, 4 $\frac{1}{4}$ miles east of Littlefield.

Dark-colored soil- - - - -	1	1
Caliche- - - - -	6	7

	Thickness (feet)	Depth (feet)
--	---------------------	-----------------

Log of well 317--Continued

Green clay- - - - -	6	13
Pale green clay and lime- -	14	27
No water sample collected. May 5, 1937.		

Well 318

Slope at east edge of draw, northeast corner SE $\frac{1}{4}$ labor 20, league 671, 4 $\frac{3}{4}$ miles southeast of Littlefield.

Soil- - - - -	1	1
Green clay- - - - -	4	5
Light-colored lime and clay-	4	9
Green clay- - - - -	3	12
Buff-colored clay- - - - -	8	20
Caliche and gravel- - - - -	4	24
No water sample collected. May 1, 1937.		

Well 319

Flat, along county road, southeast corner labor 5, league 687, 5 $\frac{1}{2}$ miles southeast of Littlefield.

Soil- - - - -	2	2
Sandy green clay and lime - -	6	8
Caliche and clay- - - - -	7	15
Buff-colored clay- - - - -	5	20
Caliche and clay- - - - -	5	25
No water sample collected. May 1, 1937.		

Well 326

Lake bottom, northwest corner labor 22, league 672, 3 $\frac{1}{2}$ miles southeast of Littlefield.

Clay soil- - - - -	5	5
Caliche and clay- - - - -	1	6
Buff-colored clay- - - - -	3	9
Caliche and clay- - - - -	2	11
Buff-colored clay and sand -	24	35
No water sample collected. Apr. 30, 1937.		

Well 327

Lake edge slope, southwest corner labor 17, league 686, 5 miles south of Littlefield.

Topsoil- - - - -	1	1
Green clay- - - - -	5	6
Pale green clay and lime- -	23	29
No water sample collected. Apr. 19, 1937.		

Well 329

Lake bed, along county road, northeast corner labor 4, league 693, 6 $\frac{1}{2}$ miles south of Littlefield.

Topsoil- - - - -	2	2
Caliche- - - - -	13	15
Greenish-brown sandy clay -	15	30
No water sample collected. Apr. 30, 1937.		

Partial analyses of water from wells in Lamb County, Texas

(Analyzed at The University of Texas under the direction of Dr. E. P. Schoch, Director of the Bureau of Industrial Chemistry, by J. E. Stullken, D. F. Riddell, H. T. Davidson and Floyd H. Ward, Chemists, and J. A. Harmaza, Martin Wieland and Jack Ramsey, Assistant Chemists. Results are in parts per million. Well numbers correspond to numbers in table of well records.)

Well No.	Owner	Depth of well (feet)	Date of Collection	Total dissolved solids (calculated)	Calcium (Ca)	Magnesium (Mg)	Sodium and Potassium (Na / K) (calculated)	Bicarbonate (HCO ₃)	Sulphate (SO ₄)	Chloride (Cl)	Total hardness as CaCO ₃ (calculated)
5	W.P.A. test well	27	Jan. 28, 1937	-	-	-	-	-	30	28	-
9	do.	24	Jan. 19, 1937	-	-	-	-	-	78	49	-
10	Halsell Cattle Co.	21	Mar. 16, 1937	1,207	-	-	-	451	447	130	-
11	W.P.A. test well	22	Jan. 19, 1937	-	-	-	-	-	26	64	-
17	--	66	Feb. 4, 1937	-	-	-	-	-	30	21	-
18	W.P.A. test well	47	do.	312	-	-	-	256	37	32	-
20	do.	25	do.	-	-	-	-	-	52	38	-
25	do.	33	Jan. 25, 1937	-	-	-	-	-	67	36	-
26	Halsell Cattle Co.	-	Mar. 16, 1937	481	-	-	-	354	84	46	-
27	W.P.A. test well	29	Jan. 25, 1937	-	-	-	-	-	52	48	-
32	do.	34	Feb. 10, 1937	3,531	-	-	-	793	1,206	750	-
33	Halsell Cattle Co.	-	Mar. 16, 1937	9,722	-	-	-	403	4,510	1,920	-
Spring											
36	Herman Harberer	165	Feb. 4, 1937	-	-	-	-	-	a/	16	-
37	Cleve Hamilton	83	do.	-	-	-	-	-	96	112	-
39	W.P.A. test well	15	Mar. 16, 1937	-	-	-	-	-	88	50	-
40	Halsell Cattle Co.	-	do.	916	-	-	-	671	139	108	-
Spring											
42	do.	21	Feb. 5, 1937	326	-	-	-	281	37	28	-
43	do.	45	Feb. 10, 1937	-	-	-	-	-	89	46	-
44	Cleve Hamilton	142	Feb. 4, 1937	-	-	-	-	-	a/	23	-
45	Halsell Cattle Co.	90	Feb. 10, 1937	436	-	-	-	323	63	52	-
46	L.C. Haliburton	71	Feb. 5, 1937	322	-	-	-	305	22	26	-
47	W.A. McCord	131	do.	292	-	-	-	268	22	26	-
48	J.W. Kelley	108	do.	309	-	-	-	299	19	24	-
49	James Duffy	79	Feb. 10, 1937	437	-	-	-	281	82	58	-
50	W.D. Howard	101	Apr. 6, 1937	319	-	-	-	275	33	30	-
52	J.F. Kelley	180	Mar. 31, 1937	242	-	-	-	232	18	17	-
53	J.D. Nix	200	do.	257	-	-	-	262	15	13	-
57	E.M. Gettis	224	do.	233	-	-	-	256	a/	15	-

a/ Sulphate less than 10 parts per million.

Partial analyses of water from wells in Lamb County--Continued

Results are in parts per million.

Well No.	Owner	Depth of well (feet)	Date of collection	Total dissolved solids (calculated)	Calcium (Ca)	Magnesium (Mg)	Sodium and Potassium (Na + K) (calculated)	Bicarbonate (HCO ₃)	Sulphate (SO ₄)	Chloride (Cl)	Total hardness as CaCO ₃ (calculated)
58	W.H. Skinner	84	Apr. 6, 1937	349	-	-	-	268	40	46	-
60	S.A. Davis	220	June 24, 1937	-	-	-	-	-	18	22	-
66	G.C. Crosby	97	Apr. 8, 1937	341	-	-	-	287	47	25	-
68	W.B. Eby	202	May 28, 1937	459	-	-	-	390	82	15	-
78	W.O. Roebuck	175	Mar. 30, 1937	368	-	-	-	305	48	32	-
79	Ada F. Crawford	183	do.	-	-	-	-	-	48	29	-
83	Halsell Cattle Co.	59	do.	375	-	-	-	323	48	27	-
84	do.	46	Apr. 5, 1937	-	-	-	-	-	73	50	-
85	J.B. Northcott	70	Mar. 16, 1937	387	-	-	-	305	59	34	-
86	B.F. Redwine	78	do.	178	-	-	-	122	22	30	-
87	Matt Nix	71	Feb. 23, 1937	-	-	-	-	-	323	156	-
88	Halsell Cattle Co.	42	do.	481	-	-	-	390	85	26	-
89	do.	20	do.	1,100	-	-	-	470	297	188	-
90	do.	39	Mar. 16, 1937	978	-	-	-	433	301	126	-
92	do.	-	Feb. 10, 1937	654	-	-	-	397	133	90	-
93	do.	33	do.	-	-	-	-	-	394	130	-
94	-- Moore	82	Feb. 23, 1937	713	-	-	-	415	202	56	-
95	W.P.A. test well	41	Feb. 24, 1937	513	-	-	-	293	144	44	-
96	Dallas Bank & Trust Co.	58	Feb. 9, 1937	1,003	-	-	-	470	258	162	-
98	Halsell Cattle Co.	46	do.	226	-	-	-	207	11	26	-
99	W.P.A. test well	29	Feb. 10, 1937	-	-	-	-	-	558	235	-
101	Halsell Cattle Co.	53	Feb. 9, 1937	1,510	-	-	-	378	635	192	-
102	do.	45	do.	351	-	-	-	354	11	29	-
103	T.H. White	73	Feb. 24, 1937	-	-	-	-	-	56	56	-
105	Sam Sanders	109	Feb. 11, 1937	-	-	-	-	-	96	98	-
106	W.P.A. test well	48	Feb. 19, 1937	326	-	-	-	378	a/	10	-
201	U.B. Porter	114	Feb. 11, 1937	528	-	-	-	146	149	126	-
204	L.R. Capps	160	Mar. 12, 1937	-	-	-	-	-	60	44	-
206	Case Brothers	248	Feb. 27, 1937	2,545	-	-	-	317	851	690	-
207	J.C. Whaley	250	Mar. 12, 1937	3,105	-	-	-	281	915	1,010	-
208	S.O. Wakeman	145	Mar. 11, 1937	-	-	-	-	-	76	90	-
209	J.B. Wingo	202	Feb. 25, 1937	346	-	-	-	244	48	50	-
210	R.N. Triplett	139	Feb. 24, 1937	509	-	-	-	201	72	155	-

a/ Sulphate less than 10 parts per million.

Partial analyses of water from wells in Lamb County--Continued

Results are in parts permillion.

Well No.	Owner	Depth to well (feet)	Date of collection	Total dissolved solids (calculated)	Calcium (Ca)	Magnesium (Mg)	Sodium and Potassium (Na / K) (calculated)	Bicarbonate (HCO ₃)	Sulphate (SO ₄)	Chloride (Cl)	Total hardness as CaCO ₃ (calculated)
211	Sudan Cemetery	198	Feb.24,1937	433	-	-	-	250	44	106	-
212	R.M. Jones	99	Feb.11,1937	435	-	-	-	207	108	72	-
216	R.M. Grissom	117	Mar.11,1937	-	-	-	-	-	132	102	-
217	City of Sudan	134	Feb.25,1937	-	-	-	-	-	88	70	-
217a	do.	134	do.	-	-	-	-	-	148	76	-
220	F.C. Whiteside	108	Mar.11,1937	588	-	-	-	146	136	176	-
221	A.W. Phillips	126	do.	518	-	-	-	146	120	146	-
222	T.M. Young	82	do.	-	-	-	-	-	120	130	-
223	--	65	Mar. 9,1937	749	-	-	-	262	112	240	-
226	B.R. Haney	220	Mar.10,1937	465	-	-	-	220	80	110	-
232	Harris Brantley	87	Mar. 9,1937	-	-	-	-	-	76	110	-
233	L.M. Brandon	79	do.	1,040	-	-	-	268	371	188	-
234	Fred Kraushar	98	Mar.22,1937	-	-	-	-	-	55	76	-
235	City of Amherst	210	Mar. 8,1937	-	-	-	-	-	96	94	-
237	J.E. Smith	181	Mar. 9,1937	-	-	-	-	-	164	126	-
238	W.H. Priddy	61	Feb.23,1937	-	-	-	-	-	124	60	-
239	Odus Moore	200	Mar. 8,1937	423	-	-	-	317	80	32	-
241	O.E. Sumner	66	Mar.22,1937	990	-	-	-	122	352	250	-
248	S.B. Pinkerton	92	do.	622	-	-	-	305	117	132	-
249	Mrs. Effie Tatum	87	Mar.10,1937	-	-	-	-	-	367	94	-
250	M.A. Parmer	158	do.	1,087	-	-	-	311	328	235	-
251	--	80	do.	770	-	-	-	311	240	112	-
253	W.P.A. test well	63	Apr. 1,1937	-	-	-	-	-	121	265	-
256	C.R. Spann	204	Apr.28,1937	-	-	-	-	-	88	82	-
259	W.P.A. test well	19	Apr. 1,1937	-	-	-	-	-	704	355	-
260	C. L. Rogers	186	do.	506	-	-	-	244	139	70	-
261	W.P.A. test well	18	Apr.12,1937	764	-	-	-	451	183	86	-
262	do.	12	do.	2,120	88	89	545	708	785	265	585
263	do.	15	do.	1,321	-	-	-	537	396	205	-
264	do.	40	Apr.13,1937	341	-	-	-	403	a/	7	-
265	do.	45	Apr.14,1937	-	-	-	-	-	176	150	-
266	J.J. Harlan	126	Apr. 9,1937	-	-	-	-	-	506	240	-
269	W.P.A. test well	14	Apr.12,1937	3,819	193	208	838	799	1,597	610	1,338
271	Eva Wells	193	do.	-	-	-	-	-	62	56	-

a/ Sulphate less than 10 parts per million.

Partial analyses of water from wells in Lamb County--Continued

Results are in parts per million.

Well No.	Owner	Depth of well (feet)	Date of collection	Total dissolved solids (calculated)	Calcium (Ca)	Magnesium (Mg)	Sodium and Potassium (Na / K) (calculated)	Bicarbonate (HCO ₃)	Sulphate (SO ₄)	Chloride (Cl)	Total hardness as CaCO ₃ (calculated)
275	H.C. Green	160	Apr. 1, 1937	709	-	-	-	293	216	104	-
276	-- Bennett	126	Apr. 9, 1937	422	-	-	-	281	89	42	-
277	B.A. Ball	104	Apr. 14, 1937	-	-	-	-	-	195	94	-
278	L.T. Green	150	Apr. 13, 1937	352	-	-	-	275	59	28	-
282	J.J.M. Sanders	138	Apr. 14, 1937	600	-	-	-	183	214	94	-
285	S.C. Tolbert & sons	126	do.	445	-	-	-	305	89	44	-
287	J.P. Barker	91	do.	642	-	-	-	281	136	140	-
289	Elwood Estate	19	Apr. 13, 1937	1,060	-	-	-	439	362	120	-
290	T.B. Elders	144	do.	553	-	-	-	323	144	54	-
291	L.C. O'Neil	150	Apr. 9, 1937	-	-	-	-	-	136	66	-
292	W.B. Mann	106	Apr. 13, 1937	-	-	-	-	-	78	34	-
293	Elwood Estate	84	Apr. 8, 1937	-	-	-	-	-	117	23	-
295	J.P. Ratliff	167	May 6, 1937	462	-	-	-	281	104	54	-
297	S.N. Twilley	139	May 7, 1937	662	-	-	-	171	260	98	-
298	W.T. Hopkins	-	May 6, 1937	-	-	-	-	-	128	68	-
299	W.O. Stacy	155	May 7, 1937	495	-	-	-	262	136	56	-
301	A.W. Stanford	163	do.	-	-	-	-	-	1,054	430	-
303	J.C. Harper	125	May 5, 1937	-	-	-	-	-	907	385	-
304	J.E. Hamilton	120	May 7, 1937	1,151	-	-	-	232	471	188	-
314	A.F. Wedel	158	Apr. 29, 1937	-	-	-	-	-	308	305	-
315	C.W. Smiley	155	May 1, 1937	707	-	-	-	293	219	100	-
322	Yellowhouse Land Company	-	Apr. 29, 1937	-	-	-	-	-	168	148	-
328	J.W. James	107	do.	-	-	-	-	-	120	52	-
332	Mrs. H.A. Gilliam	102	Mar. 22, 1937	1,426	-	-	-	214	425	415	-
336	W. Holman	75	Mar. 11, 1937	900	-	-	-	287	260	190	-
339	S.A. Williams	103	Mar. 12, 1937	345	-	-	-	134	80	78	-
340	Frances Albus	79	do.	400	-	-	-	256	72	56	-
341-342	City of Littlefield	136 } 130 }	Oct. 6, 1937 Composite sample.	474	61	41	60	310	81	74	321

MAP OF LAMB COUNTY, TEXAS

SHOWING LOCATIONS OF WATER WELLS LISTED

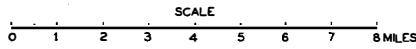

FIELD WORK BY
W. L. BROADHURST
PROJECT SUPERINTENDENT
W. P. A. PROJECT 2070

BASE COMPILED FROM
LAND OWNERSHIP MAP
AND FIELD NOTES

- EXPLANATION -

- | | |
|---|---|
| <ul style="list-style-type: none"> ○ WELL WITH HANDPUMP, BUCKET OR BAILER ⊕ WELL WITH WINDMILL OR SMALL POWER PUMP ⊙ WELL WITH PUMPING PLANT - 5 HORSE POWER OR LARGER ⚡ WELL DRILLED TO TEST FOR OIL OR GAS □ TEST WELL DRILLED BY W.P.A. LABOR | <ul style="list-style-type: none"> ○ UNUSED WELL ⊕ SPRING ⊕ ESCARPMENT ○ SINK ○ SAND HILL ⊕ EARTHEN TANK OR RESERVOIR — IMPROVED ROAD - - - UNIMPROVED ROAD |
|---|---|

TEXAS BOARD OF
WATER ENGINEERS
ASSISTED BY
U. S. GEOLOGICAL SURVEY

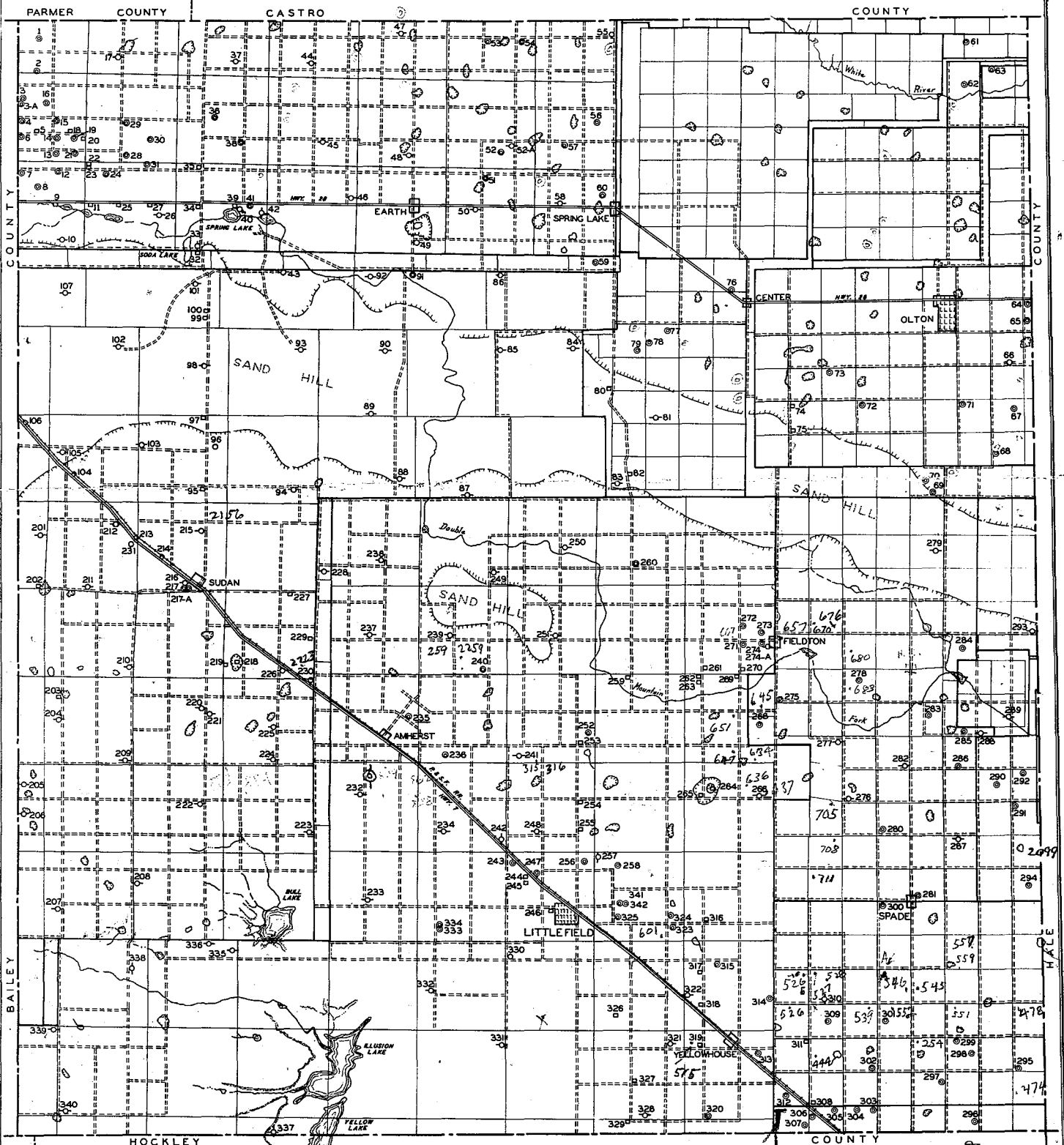

2245

W.L.

047

used of wells

2876

1970